



# External Drive Piezo Transducer Specification

## Series FZ-V1538

Model Number: 153PA42280LFLA

Version 1.0

Address: 28 Genting Lane, #08-07 Platinum 28, Singapore 349585

Tel: +65-6493 5035

Fax: +65-6493 5037

Website: <http://www.flezon.com>

Email: [flezon@flezon.com](mailto:flezon@flezon.com)

## 1. ELECTRICAL SPECIFICATIONS



Model No.: 153PA42280LFLA

Description PZ TRANSDUCER 12V L/W ABS SP RoHS

<i>MODEL NO.</i>	<b><u>153PA42280LFLA</u></b>
<i>SOUND PRESSURE LEVEL</i>	90.0 dBA min. ( 12.0V p-p Square Wave , 30 cm , 2800 Hz )
<i>CAPACITANCE</i>	35000 pF $\pm$ 30 % at 120 Hz
* <i>MAX. INPUT VOLTAGE</i>	30.0 V p-p
<i>OPERATING TEMPERATURE</i>	-20 ~ +60 ° C
<i>TERMINAL</i>	LEADWIRE
<i>HOUSING MATERIAL</i>	ABS
* <i>WEIGHT</i>	3.0 g

## 2. PHYSICAL DIMENSION



All dimensions stated are in mm

Tolerance:  $\pm 0.5\text{mm}$

### TOP VIEW

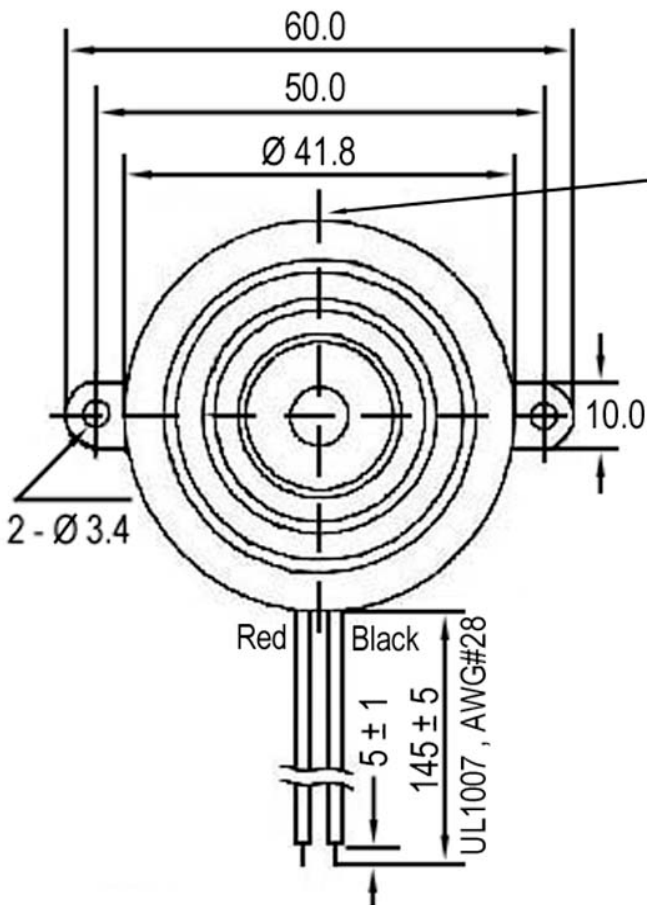

### SIDE VIEW

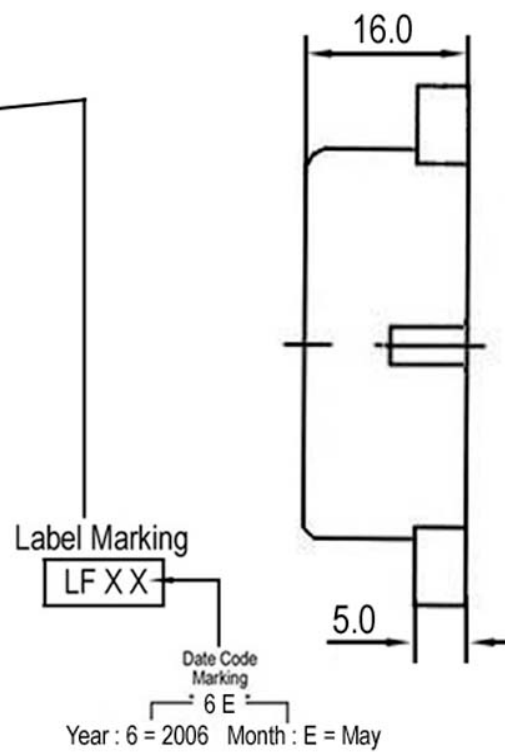

FLEZON

## Revision History

Revision	Date	Description
1.0	2006/05	First release

FLEZON CONFIDENTIAL