

THIS DRAWING IS UNPUBLISHED. RELEASED FOR PUBLICATION AUG ,2006.  
 © COPYRIGHT BY TYCO ELECTRONICS CORPORATION. ALL RIGHTS RESERVED.

LOC	DIST	REVISIONS			
P	LTR	DESCRIPTION	DATE	DWN	APVD
DW	-				
	D	REVISED (ECR-09-010844), OBSOLETE 4-5	18MAY09	SC	WK

NOTES:

- MATERIAL:  
 HOUSING: PA46 WITH 30% GF, UL 94V-0, COLOR: BLUE(661C) OR BLACK.  
 CONTACTS: BRASS.  
 SHELL: SPCC.  
 BOARDLOCKS: SPCC.  
 SCREWS: STEEL.  
 RIVET: BRASS.
  - FINISH:  
 CONTACTS: GOLD (SEE TABLE) PLATED ON CONTACT AREA,  
 2.54um[100u"]MIN. MATTE-TIN ON SOLDER TAIL,  
 1.27um[50u"]MIN. NICKEL UNDERPLATED OVER ALL.  
 SHELL: 2.54um[100u"]MIN. NICKEL PLATED.  
 BOARDLOCK: 2.54um[100u"] BRIGHT-TIN PLATED.  
 1.27um[50u"]MIN. NICKEL UNDERPLATED OVER ALL.  
 SCREWS: 2.54um[100u"]MIN. NICKEL PLATED.  
 RIVET: 1.27um[50u"]MIN. NICKEL PLATED.
- △ RECOMMENDED PCB THICKNESS: 1.6mm.
- WAVE SOLDER CAPABLE TO 265°C PER TE SPEC 109-202, CONDITION B.
  - THREADED INSERTS AND SCREWLOCKS MUST WITHSTAND TIGHTEN TORQUE:  
 5.5Kg-cm MAX.
  - THREADED INSERTS AND SCREWLOCKS MUST WITHSTAND LOOSEN TORQUE:  
 1Kgf-cm MIN.

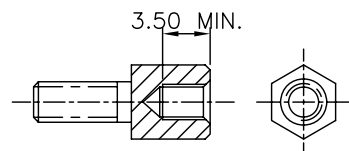
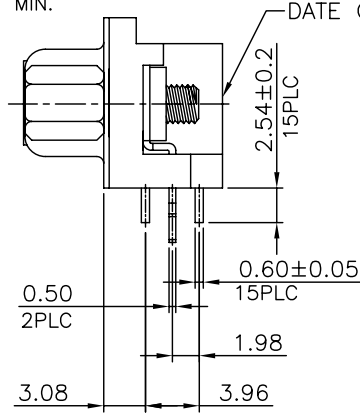
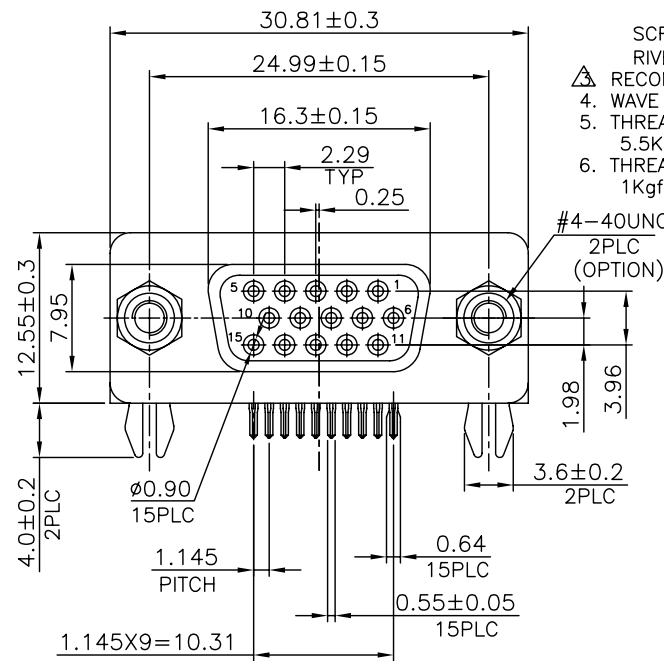
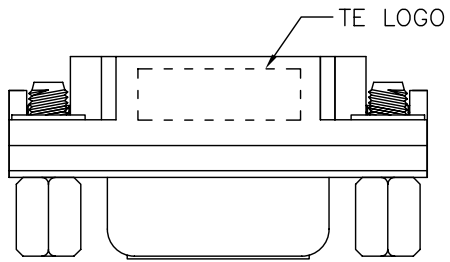

SCREW DETAIL

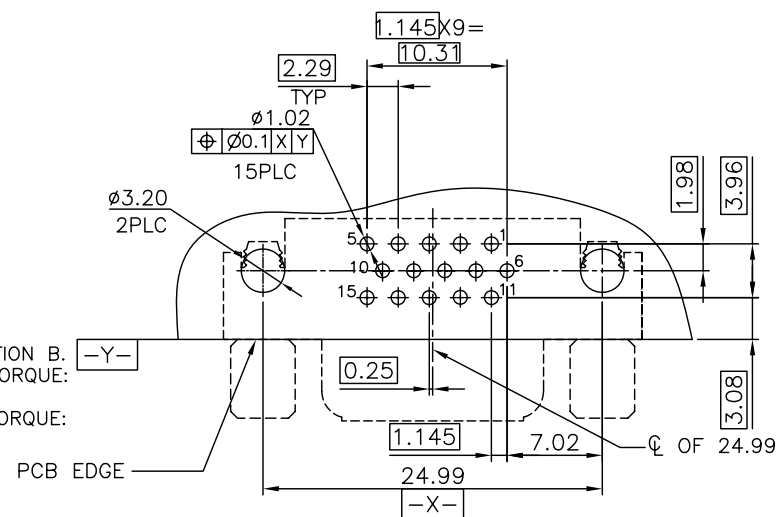

RECOMMENDED PCB LAYOUT (TOP VIEW), TOLERANCE: ±0.05

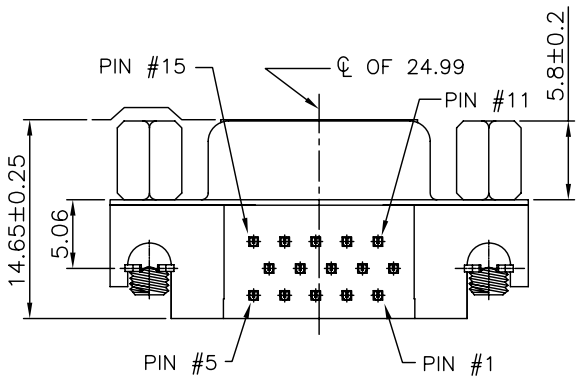

OBSOLETE	5.68	G/F	W/O	BLACK	5-1734078-5
		G/F	W/O	BLUE/661C	5-1734078-4
	7.6	G/F	W/	BLACK	4-1734078-6
		G/F	W/	BLUE/661C	4-1734078-4
OBSOLETE	7.6	0.508µm[20µ"] MIN	W/	BLUE/661C	3-1734078-5
		G/F	W/O	BLACK	1-1734078-5
	5.68	G/F	W/O	BLUE/661C	1-1734078-4
		7.6	0.762µm[30µ"] MIN	W/	BLUE/661C
7.6	G/F		W/	BLACK	1734078-6
	7.6	G/F	W/	BLUE/661C	1734078-4
NET WEIGHT(g)			GOLD PLATING	SCREW	HSG/COVER COLOR

THIS DRAWING IS A CONTROLLED DOCUMENT.		DWN	18MAY2009	Tyco Electronics Corporation	
		CHK	18MAY2009	Tyco Electronics Taipei, Taiwan	
		APVD	18MAY2009	NAME	
DIMENSIONS: MM		PRODUCT SPEC		D-SUB, 15P, RECEPTACLE, RIGHT ANGLE	
TOLERANCES UNLESS OTHERWISE SPECIFIED:		QUALIFICATION TEST REPORT		RESTRICTED TO	
0 PLC ± -		501-57956		-	
1 PLC ± 0.30		WEIGHT		SCALE	
2 PLC ± 0.20		7.4 GRAMS		SHEET	
3 PLC ± 0.15		CUSTOMER DRAWING		1 OF 2	
4 PLC ± -		A300779		REV	
ANGLES ± 3'		C=1734078		D	
MATERIAL SEE NOTE		FINISH SEE NOTE			

4

3

2

1

THIS DRAWING IS UNPUBLISHED. RELEASED FOR PUBLICATION AUG ,2006.

© COPYRIGHT BY TYCO ELECTRONICS CORPORATION. ALL RIGHTS RESERVED.

LOC	DIST	REVISIONS			
P	LTR	DESCRIPTION	DATE	DWN	APVD
DW		SEE SHEET 1.			

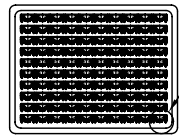
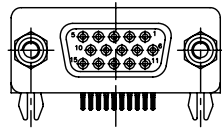

SEE DETAIL C

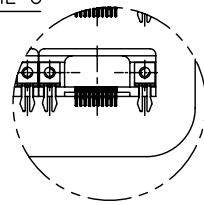

DETAIL C SCALE 8:1

TRAY LAYOUT

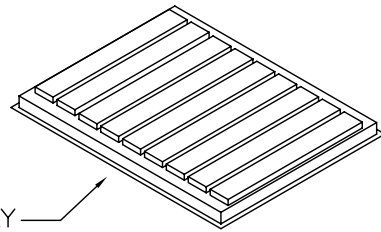
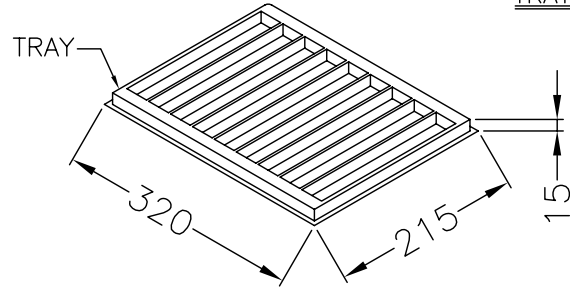

COVER TRAY

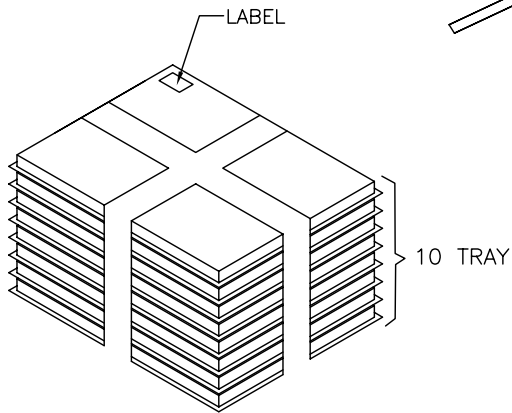

LABEL

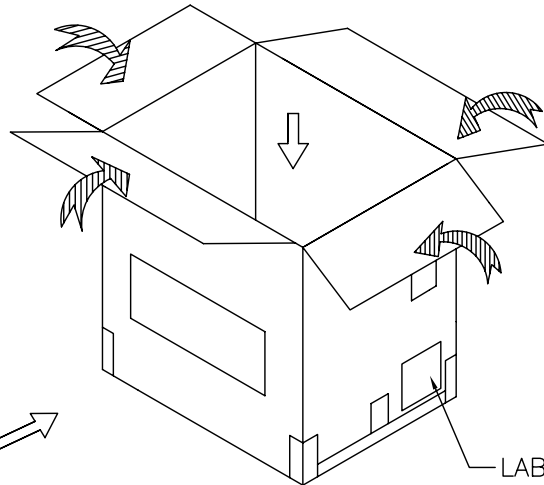

SHIPPING BOX

LABEL

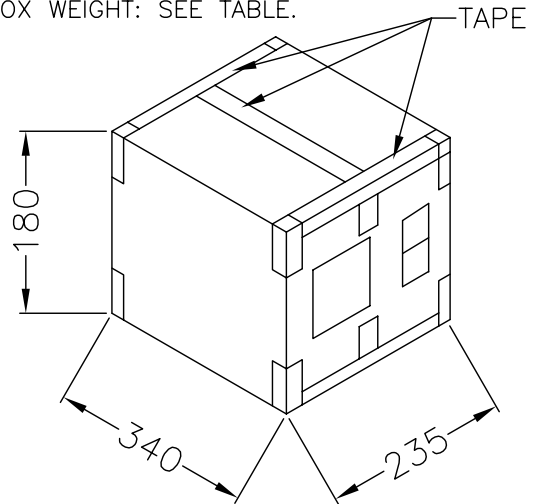

SHIPPING BOX

NOTES:

- MATERIAL:  
TRAY: PVC  
SHIPPING CARTON: CORRUGATED FIBERBOARD
- DIMENSION:  
TRAY: L=320, W=215, H=15.  
SHIPPING BOX: L=340, W=235, H=180.
- QUANTITY: SEE TABLE.
- SHIPPING BOX WEIGHT: SEE TABLE.

W/O	7.0	5.7	100	10	1000
W/	8.9	7.6	100	10	1000
SCREW	G.W(KG)	N.W(KG)	PCS/TRAY	TRAY/SHIPPING BOX	PCS/SHIPPING BOX

DIMENSIONS: MM		TOLERANCES UNLESS OTHERWISE SPECIFIED:		Tyco Electronics Corporation Taipei, Taiwan	
0 PLC	±	1 PLC	±	NAME	
2 PLC	±	3 PLC	±	D-SUB, 15P, RECEPTACLE, RIGHT ANGLE	
4 PLC	±	ANGLES	±	SIZE	CAGE CODE
FINISH				A3	00779
MATERIAL				DRAWING NO	RESTRICTED TO
				C=1734078	
CUSTOMER DRAWING				SCALE	SHEET
					2 OF 2
				REV	D