



E-Z-TRIM® Potentiometer
Model 3007
Commercial
Wirewound Element

FEATURES

- Low cost.
- Subminiature size and space-saving .17 x .31 x .75 configuration
- Wirewound resistance element.
- Stable wiper setting due to self-locking adjustment screw.
- 20-turn screwdriver adjustment.
- Wiper assembly idles at both ends of travel, preventing damage from forced adjustments.

Actual Size



OBSOLETE 1980

STANDARD RESISTANCES

Resistance (ohms)	Part Numbers*	
	3007P Printed Circuit Pins	Nominal Resolution (percent)
10	3007P-1-100	1.7
20	3007P-1-200	1.5
50	3007P-1-500	1.0
100	3007P-1-101	0.8
200	3007P-1-201	0.7
500	3007P-1-501	0.5

SPECIAL RESISTANCES AVAILABLE FROM 10 TO 50,000 OHMS

Resistance (ohms)	Part Numbers*	
	3007P Printed Circuit Pins	Nominal Resolution (percent)
1,000	3007P-1-102	0.5
2,000	3007P-1-202	0.4
5,000	3007P-1-502	0.3
10,000	3007P-1-103	0.3
20,000	3007P-1-203	0.2
25,000	3007P-1-253	0.2
50,000	3007P-1-503	0.2

*The last three digits of the part number represent the resistance in standard code.

Model 3007 E-Z-TRIM® Potentiometer

SPECIFICATIONS

ELECTRICAL CHARACTERISTICS

Standard Resistance Range	10 to 50,000 ohms
Resistance Tolerance*	±10% standard; closer tolerances available
Absolute Minimum Resistance*	0.5% or 1.0 ohm, whichever is greater
Continuity*	Maintained for full mechanical range
Noise During Adjustment*	100 ohms ENR maximum
Insulation Resistance, 500 volts DC	100 megohms minimum
Resolution (see chart on front)	0.2 to 1.7%

ENVIRONMENTAL CHARACTERISTICS

Power Rating:	
40°C Ambient	1.0 watt
125°C Ambient	0 watt
Operating Temperature Range	-55° to +125°C
Temperature Coefficient:	±100 ppm/°C maximum
Humidity, MIL-STD-202C, Method 103B	20 megohms minimum insulation resistance after removal from chamber
Vibration	20Gs
Contact Bounce	0.1 millisecond maximum
Wiper Shift, Maximum	2.0%

Shock	50Gs
Contact Bounce and Wiper Shift	Same as vibration
Load Life	1,000 hours, 1 watt at 40°C
Resistance Shift, Maximum	2%
Mechanical Life	200 cycles without discontinuity
Dielectric Strength	
Room Conditions	1,000 volts AC minimum
80,000 feet (0.8" Hg)	250 volts AC minimum

PHYSICAL CHARACTERISTICS

Shaft Torque	5.0 oz.-in. maximum
Markings*	Manufacturer's name, wiring diagram, date code, resistance and manufacturer's part number (customer's part number optional)
Mechanical Adjustment	20 turns nominal
Mechanical Stops	Wiper assembly idles
Weight	Approximately 0.1 oz.
Terminals	Printed circuit pins

*Inspection Note: Statistical sampling performed to insure highest quality.
 Specification Note: Closer performance tolerances can be supplied upon request.
 Specifications are subject to change without notice.

3007

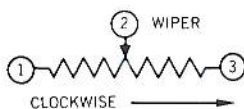
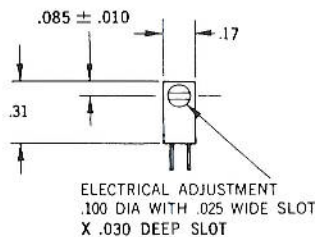
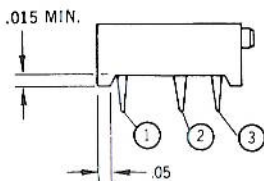
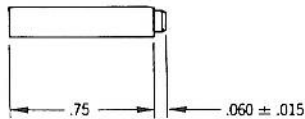

TOLERANCES: EXCEPT WHERE NOTED
 DECIMALS: .XX ± .010, XXX ± .005

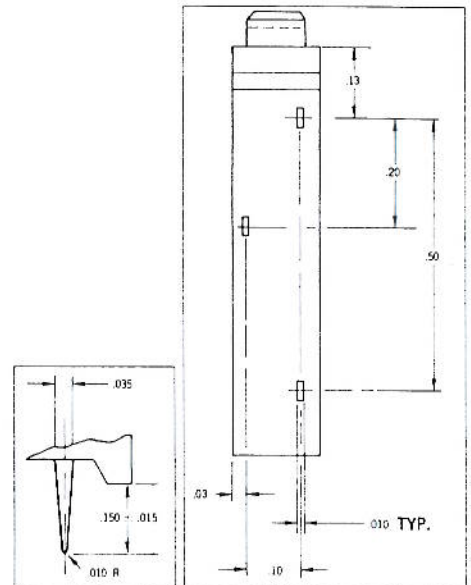

BOURNS