

Specifications: **PSB Series**

Features:

- PSB is supplied with the clamp in the open position
- Double captive screws
- Elevator clamp system
- Testing points/holes
- 2 and 3 positions single mold
- Up to 30 positions modular
- Housing is resistant to chlorinated solvents, with no dioxin or detrimental to health halogens
- Positions are contacts *per row*, not *total* contacts
- All PSB and MSB blocks can be interlocked to form custom configurations
- Every position of this product is mechanically and electrically tested during assembly to ensure a 100% defect free product
- Minimum 5 microns of tin plating on terminal for easy soldering

Electrical

Current: 13.5A @ 300V
 Wire Range: 16-30 AWG
 Wire Section: (mm²) 0.05 to 1.5mm²
 Pin Dimension: 0.9mm x 0.5mm
 CR: <15mΩ

Operating temp: -40°C - +110°C
 Stripping Length: 5mm
 Torque: 0.5 Nm
 PCB Holes: min 1.1mm
 PCB Thickness: max 2.4mm
 Climatic Category: 40/110/21 Acc. To IEC 68-1

Materials

Housing: Polyamide 6,6 (UL 94V-O)
 Clamp: Copper Alloy, Ni plated
 Terminal: Copper Alloy, Tin-plated
 Screw: M3, Copper Alloy, Ni plated
 Colors Available: Green and Black

Marking

Numbered marking strips for 5 and 5.08mm centers

Numbered	Order Number
1-10	ESA014000110
11-20	ESA014001120
21-30	ESA014002130
31-40	ESA014003140
41-50	ESA014004150

Ink marking by factory (specify in order number):

Factory ink is permanent and will not rub off.

Ink has fluorescent tint for greater visibility

0 = no printing

A = upside down printing (consecutive #'s R to L)

B = regular printing (consecutive #'s L to R)

Custom markings are welcome with minimum order - Contact factory

13.5A 300V 5 and 5.08mm

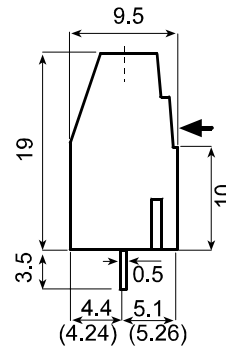
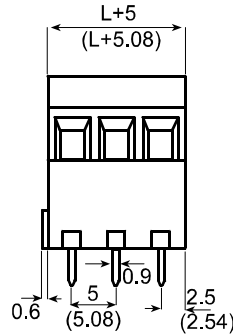
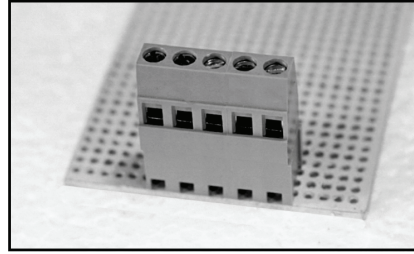

PCB Layout

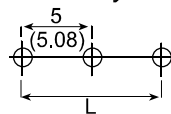

Dimensions

n = number of poles

L=(n-1) x 5.00 (for 5.00mm spacing)

L=(n-1) x 5.08 (for 5.08mm spacing)

(Also available in 10mm and 10.16mm centers)

Ordering Information

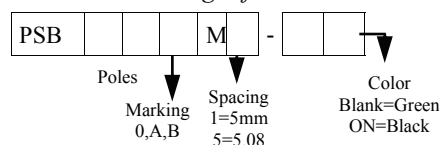

13.5A 300V 5 and 5.08mm

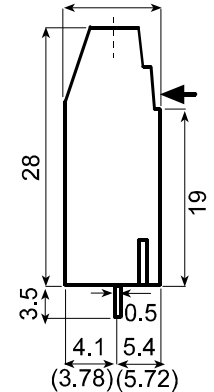
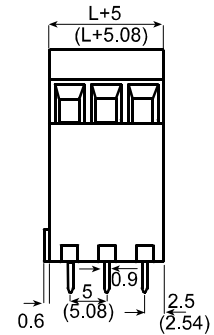
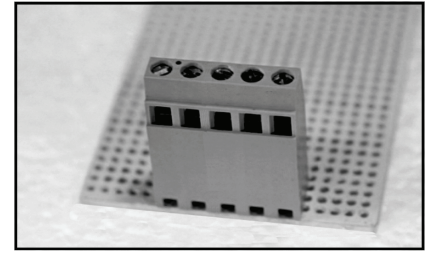

PCB Layout

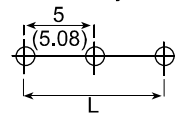

Dimensions

n = number of poles

L=(n-1) x 5.00 (for 5.00mm spacing)

L=(n-1) x 5.08 (for 5.08mm spacing)

(Also available in 10mm and 10.16mm centers)

Ordering Information

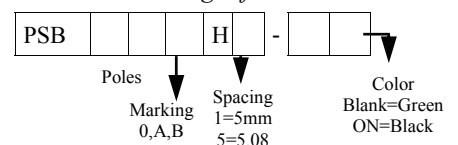

PSB D Series

13.5A 300V

5 and 5.08mm

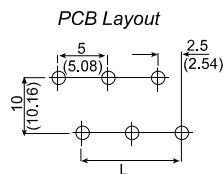
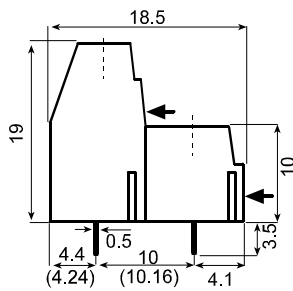
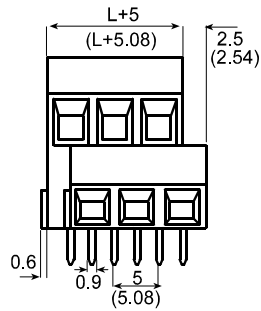
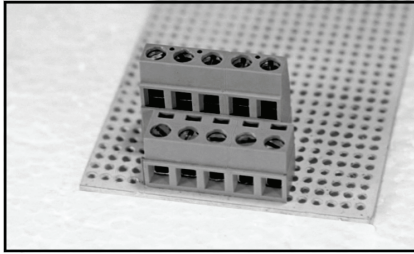

Dimensions

n = number of poles

$L=(n-1) \times 5.00$ (for 5.00mm spacing)

$L=(n-1) \times 5.08$ (for 5.08mm spacing)

Ordering Information

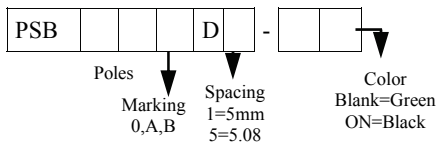

PSB K Series

13.5A 300V

5 and 5.08mm

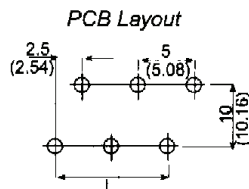
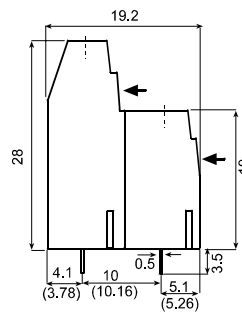
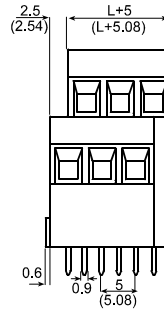
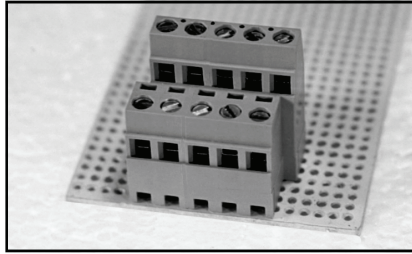

Dimensions

n = number of poles

$L=(n-1) \times 5.00$ (for 5.00mm spacing)

$L=(n-1) \times 5.08$ (for 5.08mm spacing)

Ordering Information

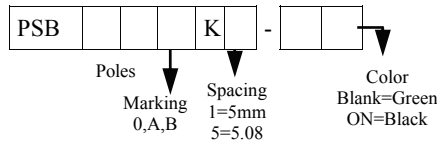

PSB T Series

13.5A 300V

5 and 5.08mm

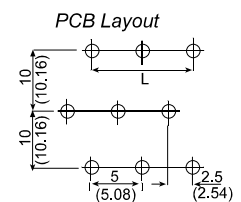
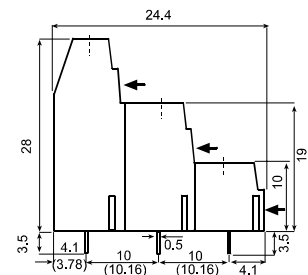
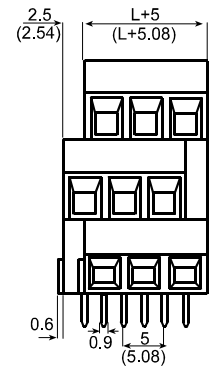
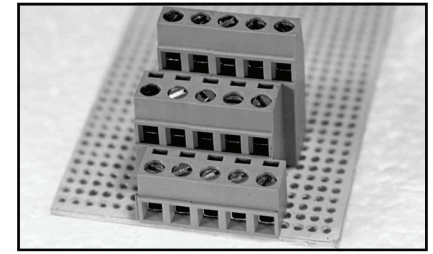

Dimensions

n = number of poles

$L=(n-1) \times 5.00$ (for 5.00mm spacing)

$L=(n-1) \times 5.08$ (for 5.08mm spacing)

(Ordering Information)

