

Outline: 产品概要

- High reliability, high consistency inductance.
高可靠性，电感值一致性好。
- High saturation current
饱和电流高。
- Lead free product, RoHS compliant.
无铅产品，符合 RoHS 指令。
- Widely used in power supply, DC-DC converter, computer and peripherals, air-condition, home electric appliance, and etc.
适用于电源，DC-DC 转换器，电脑及其外围设备，空调，家用电器等。
- Operating temperature : $-40^{\circ}\text{C} \sim +125^{\circ}\text{C}$
(Including coil's temperature rise)
工作温度： $-40^{\circ}\text{C} \sim +125^{\circ}\text{C}$ (包含线圈发热)

1 Appearance and dimensions (mm) 外形尺寸

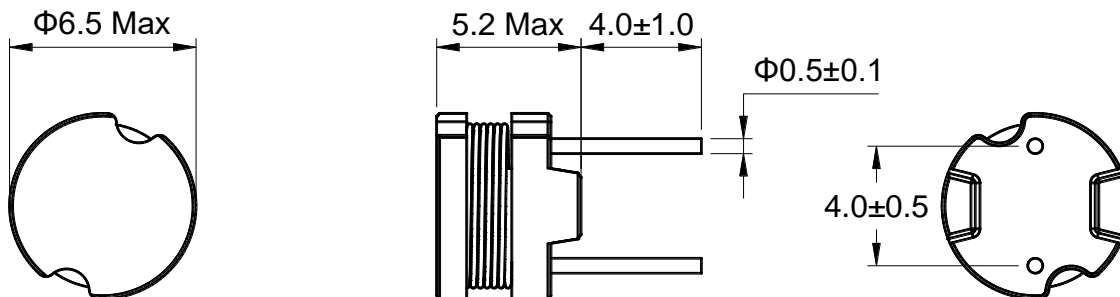

2 Marking 印字标识



※ Marking is available if needed.
如果需要，产品可印字。

3 Reference hole pattern (mm) 参考焊孔尺寸

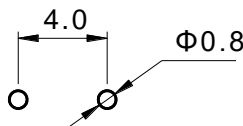

4 Schematic 原理图

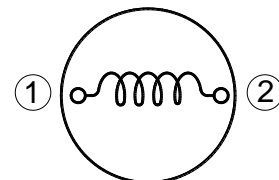

5 Electrical characteristics

电气特性

Part No. 型号	Inductance (μH) 电感值 ※1	D.C.R. (mΩ) 直流电阻		Saturation current (A) 饱和电流 ※2		Temperature rise current (A) 温升电流 ※3
		Typical	Max	Typical	Max	Typical
PKS0605-1R2M	1.20 ±20%	10.1	12.1	7.10	5.68	5.87
PKS0605-2R2M	2.20 ±20%	14.4	17.3	5.80	4.64	4.74
PKS0605-3R3M	3.30 ±20%	20.7	24.8	4.60	3.68	4.04
PKS0605-4R7M	4.70 ±20%	28.2	33.9	3.80	3.04	3.39
PKS0605-6R8M	6.80 ±20%	43.5	52.2	3.20	2.56	2.73
PKS0605-8R2M	8.20 ±20%	51.9	62.3	2.90	2.32	2.50
PKS0605-100K	10.0 ±10%	61.8	74.1	2.70	2.16	2.29
PKS0605-120K	12.0 ±10%	74.6	89.6	2.40	1.92	2.08
PKS0605-150K	15.0 ±10%	87.9	105	2.20	1.76	1.92
PKS0605-180K	18.0 ±10%	106	128	2.00	1.60	1.75
PKS0605-220K	22.0 ±10%	135	162	1.85	1.48	1.55
PKS0605-270K	27.0 ±10%	156	188	1.65	1.32	1.45
PKS0605-330K	33.0 ±10%	193	232	1.50	1.20	1.26
PKS0605-390K	39.0 ±10%	214	257	1.40	1.12	1.23
PKS0605-470K	47.0 ±10%	270	324	1.23	0.98	1.10
PKS0605-560K	56.0 ±10%	312	374	1.12	0.90	1.02
PKS0605-680K	68.0 ±10%	384	461	1.02	0.82	0.92
PKS0605-820K	82.0 ±10%	436	524	0.95	0.76	0.86
PKS0605-101K	100 ±10%	543	652	0.83	0.66	0.80
PKS0605-121K	120 ±10%	664	797	0.77	0.62	0.65
PKS0605-151K	150 ±10%	813	976	0.70	0.56	0.59
PKS0605-181K	180 ±10%	922	1,107	0.63	0.50	0.55
PKS0605-221K	220 ±10%	1,154	1,385	0.57	0.46	0.49
PKS0605-271K	270 ±10%	1,363	1,636	0.52	0.42	0.46
PKS0605-331K	330 ±10%	1,869	2,243	0.45	0.36	0.39
PKS0605-391K	390 ±10%	2,083	2,500	0.42	0.34	0.37
PKS0605-471K	470 ±10%	2,406	2,887	0.38	0.30	0.34
PKS0605-561K	560 ±10%	3,040	3,648	0.37	0.30	0.30
PKS0605-681K	680 ±10%	3,560	4,272	0.31	0.25	0.28
PKS0605-821K	820 ±10%	4,560	5,472	0.30	0.24	0.24
PKS0605-102K	1,000 ±10%	5,117	6,140	0.27	0.22	0.23

■ All data is tested based on 25°C ambient temperature.
所有数据基于环境温度 25°C条件下测试。

※1 Inductance measure condition at 1kHz,0.25V.
电感测试条件为 1kHz,0.25V。

※2 Saturation current : the value of DC current when the inductance decrease 20% of its initial value.
饱和电流 : 电感值下降其初始值的 20%时所加载的直流电流值。

※3 Temperature rise current : the actual value of DC current when the temperature rise is ΔT40°C(Ta=25°C).
温升电流 : 使产品温度上升到 ΔT40°C时所加载的实际直流电流值(Ta=25°C)。

※ Special remind : Circuit design, component placement, PWB size and thickness, cooling system and etc. all will affect the product temperature. Please verify the product temperature in the final application.
特别提醒 : 线路设计, 组件布局, 印刷线路板(PWB)尺寸及厚度, 散热系统等均会影响产品温度。请务必在最终应用时, 验证产品发热状况。

6 Saturation current VS temperature rise current curve 饱和电流 VS 温升电流曲线

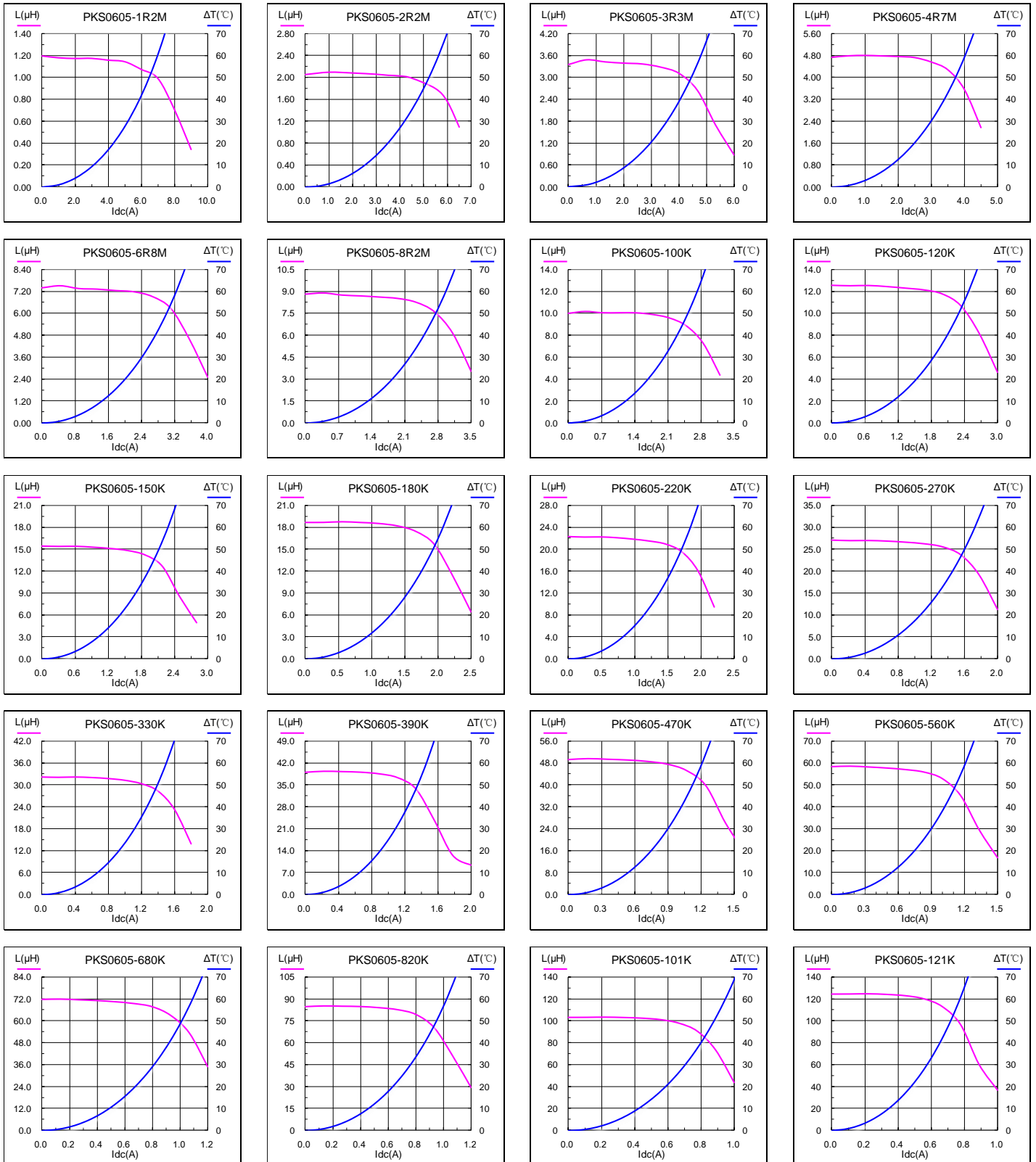

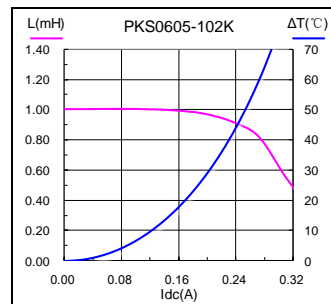
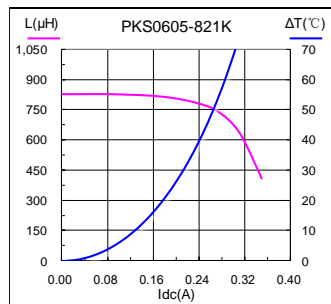
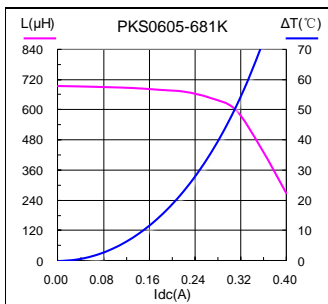
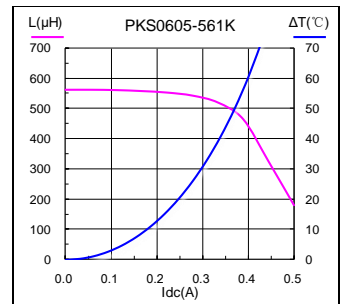
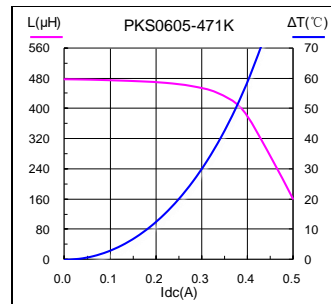
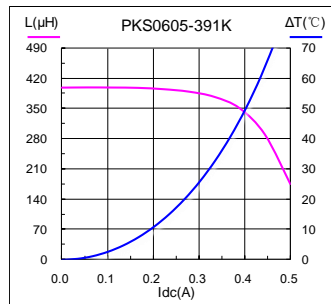
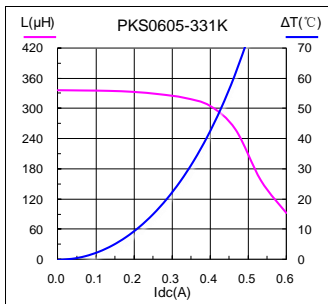
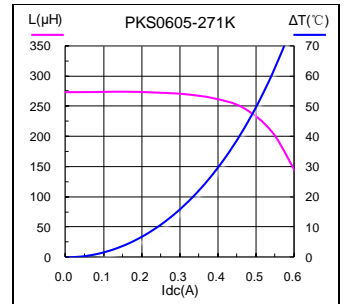
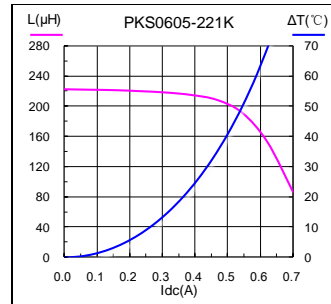
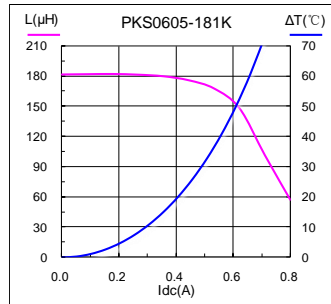
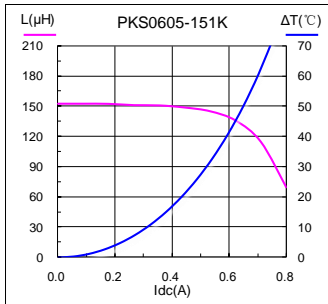

7 Packing specification 包装规格

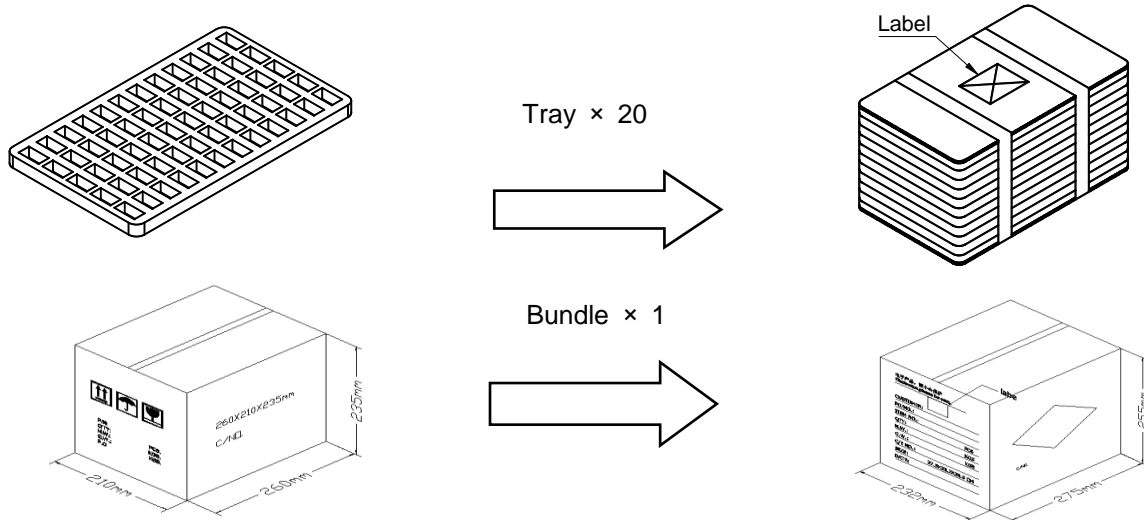

7.2 Carton dimensions and packing quantity 包装箱尺寸和包装数量

■ Inner Carton : 260×210×235mm
内包装箱

■ Out Carton : 275×232×255mm
外包装箱

Product Series 产品系列	Quantity / Tray 数量 / 盘	Inner Carton Quantity 内盒 包装数量	Out Carton Quantity 外箱 包装总数量
PKS0605	140pcs	(140×20) = 2800pcs	(2800×1) = 2800pcs

7.3 Label making 标签标识

The following items will be marked on the bag of product label and shipping label.
以下项目将明确标识于产品包装袋标签以及运输标签上。

Production Label 产品标签
■ Part No. 产品型号
■ Electrical Information 产品电性信息
■ Quantity 数量
■ Packing No. 包装流水号

Shipping Label 运输标签
■ Customer Name 客户名称
■ Customer Part No. 客户型号
■ Supplier Part No. 供应商型号
■ Supplier Name 供应商名称
■ Country of origin 产品产地