

Outline: 产品概要

- High reliability, high consistency inductance.
高可靠性，电感值一致性好。
- High saturation current
饱和电流高。
- Lead free product, RoHS compliant.
无铅产品，符合 RoHS 指令。
- Widely used in power supply, DC-DC converter, computer and peripherals, air-condition, home electric appliance, and etc.
适用于电源，DC-DC 转换器，电脑及其外围设备，空调，家用电器等。
- Operating temperature : -40°C ~ +125°C
(Including coil's temperature rise)
工作温度：-40°C ~ +125°C (包含线圈发热)

1 Appearance and dimensions (mm) 外形尺寸

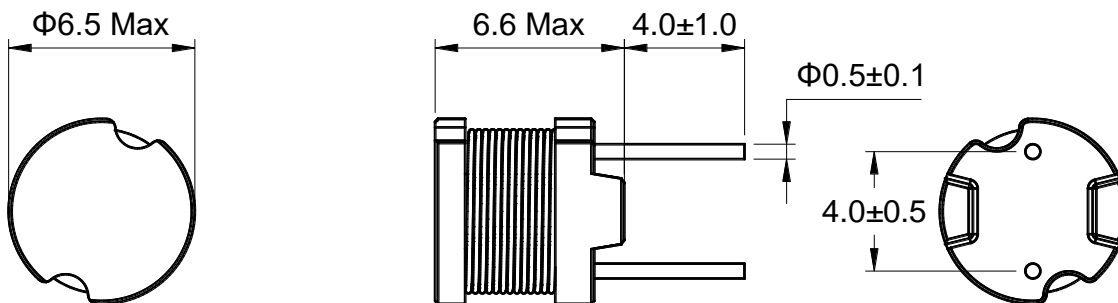

2 Marking 印字标识



3 Reference hole pattern (mm) 参考焊孔尺寸

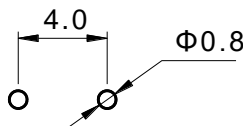

4 Schematic 原理图

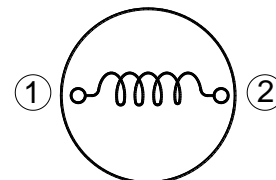

※ Marking is available if needed.
如果需要，产品可印字。

5 Electrical characteristics

电气特性

Part No. 型号	Inductance (μH) 电感值 ※1	D.C.R. (mΩ) 直流电阻		Saturation current (A) 饱和电流 ※2		Temperature rise current (A) 温升电流 ※3
		Typical	Max	Typical	Max	Typical
PKS0606-1R2M	1.20 ±20%	10.5	12.6	8.00	6.40	5.64
PKS0606-2R2M	2.20 ±20%	13.8	16.5	6.00	4.80	4.70
PKS0606-3R3M	3.30 ±20%	17.0	20.5	5.40	4.32	4.21
PKS0606-4R7M	4.70 ±20%	22.6	27.1	4.15	3.32	3.64
PKS0606-6R8M	6.80 ±20%	27.5	33.0	3.70	2.96	3.43
PKS0606-8R2M	8.20 ±20%	31.4	37.7	3.25	2.60	3.18
PKS0606-100K	10.0 ±10%	37.6	45.1	3.00	2.40	2.91
PKS0606-120K	12.0 ±10%	41.9	50.3	2.75	2.20	2.87
PKS0606-150K	15.0 ±10%	54.3	65.2	2.38	1.90	2.44
PKS0606-180K	18.0 ±10%	59.9	71.9	2.30	1.84	2.19
PKS0606-220K	22.0 ±10%	77.7	93.2	2.00	1.60	1.97
PKS0606-270K	27.0 ±10%	87.9	105	1.80	1.44	1.84
PKS0606-330K	33.0 ±10%	110	132	1.71	1.37	1.65
PKS0606-390K	39.0 ±10%	134	161	1.52	1.22	1.48
PKS0606-470K	47.0 ±10%	152	182	1.26	1.01	1.44
PKS0606-560K	56.0 ±10%	173	208	1.22	0.98	1.31
PKS0606-680K	68.0 ±10%	213	255	1.18	0.94	1.19
PKS0606-820K	82.0 ±10%	254	304	1.08	0.86	1.09
PKS0606-101K	100 ±10%	336	403	0.95	0.76	0.92
PKS0606-121K	120 ±10%	419	503	0.84	0.67	0.85
PKS0606-151K	150 ±10%	487	584	0.78	0.62	0.78
PKS0606-181K	180 ±10%	544	653	0.70	0.56	0.74
PKS0606-221K	220 ±10%	694	833	0.65	0.52	0.65
PKS0606-271K	270 ±10%	845	1,014	0.61	0.49	0.55
PKS0606-331K	330 ±10%	1,061	1,273	0.53	0.42	0.49
PKS0606-391K	390 ±10%	1,192	1,430	0.49	0.39	0.46
PKS0606-471K	470 ±10%	1,431	1,717	0.45	0.36	0.42
PKS0606-561K	560 ±10%	1,603	1,924	0.42	0.34	0.40
PKS0606-681K	680 ±10%	2,215	2,658	0.37	0.30	0.36
PKS0606-821K	820 ±10%	2,521	3,025	0.33	0.26	0.33
PKS0606-102K	1,000 ±10%	3,472	4,166	0.30	0.24	0.27

- All data is tested based on 25°C ambient temperature.
所有数据基于环境温度 25°C条件下测试。

※1 Inductance measure condition at 1kHz,0.25V.
电感测试条件为 1kHz,0.25V。

※2 Saturation current : the value of DC current when the inductance decrease 20% of its initial value.
饱和电流 : 电感值下降其初始值的 20%时所加载的直流电流值。

※3 Temperature rise current : the actual value of DC current when the temperature rise is ΔT40°C(Ta=25°C).
温升电流 : 使产品温度上升到 ΔT40°C时所加载的实际直流电流值(Ta=25°C)。

※ Special remind : Circuit design, component placement, PWB size and thickness, cooling system and etc. all will affect the product temperature. Please verify the product temperature in the final application.
特别提醒 : 线路设计, 组件布局, 印刷电路板(PWB)尺寸及厚度, 散热系统等均会影响产品温度。
请务必在最终应用时, 验证产品发热状况。

6 Saturation current VS temperature rise current curve 饱和电流 VS 温升电流曲线

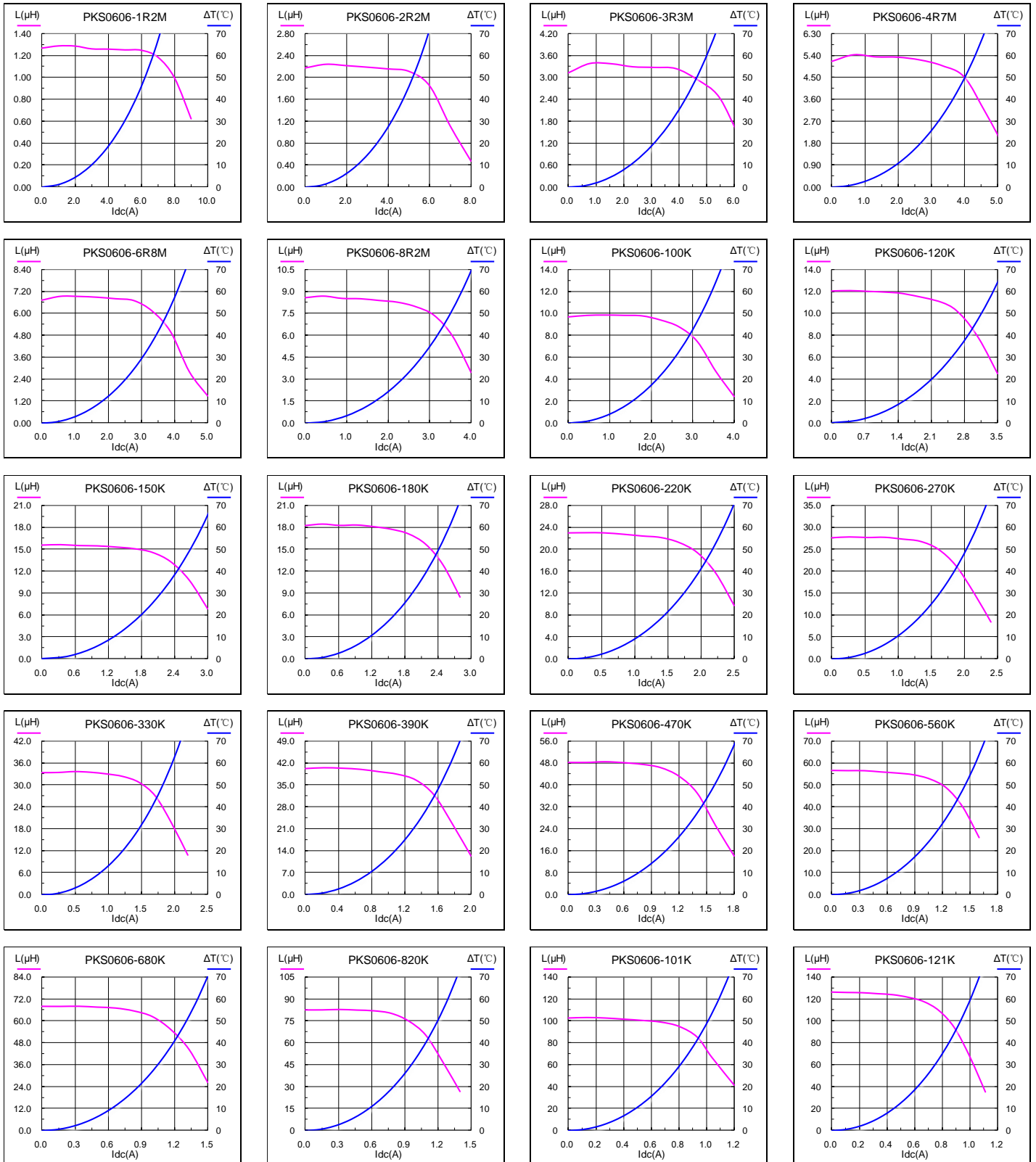

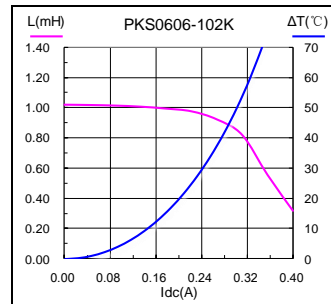
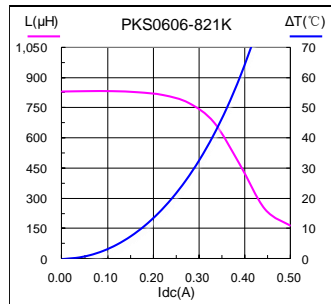
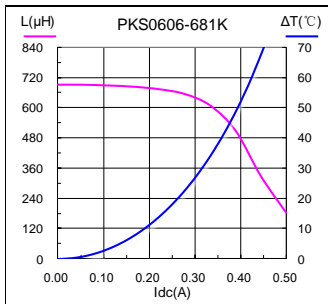
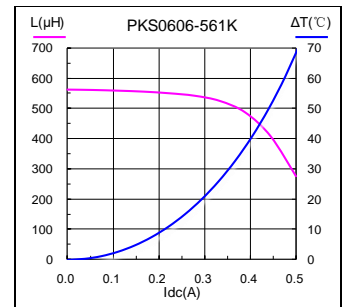
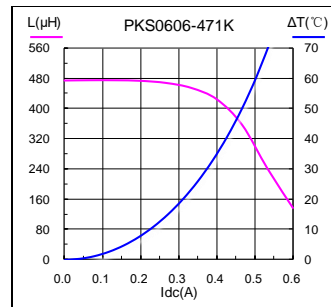
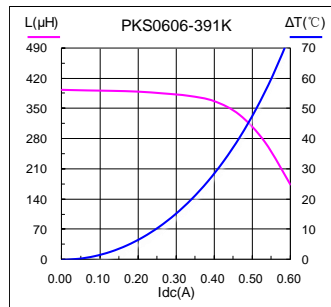
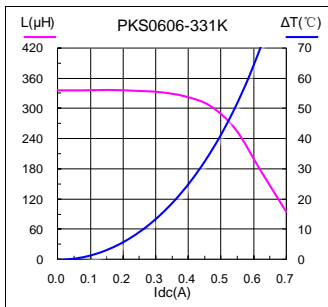
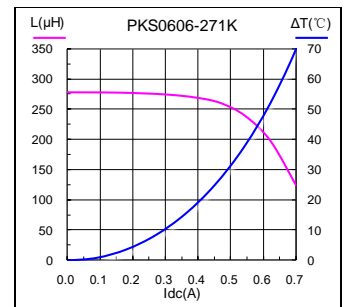
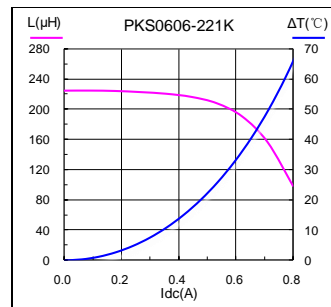
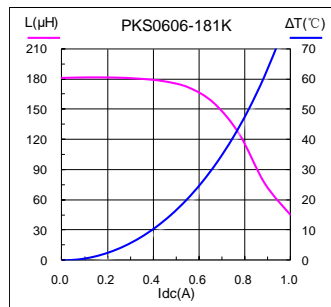
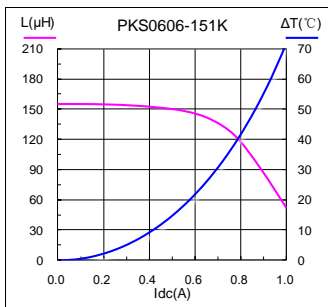

7 Packing specification

包装规格

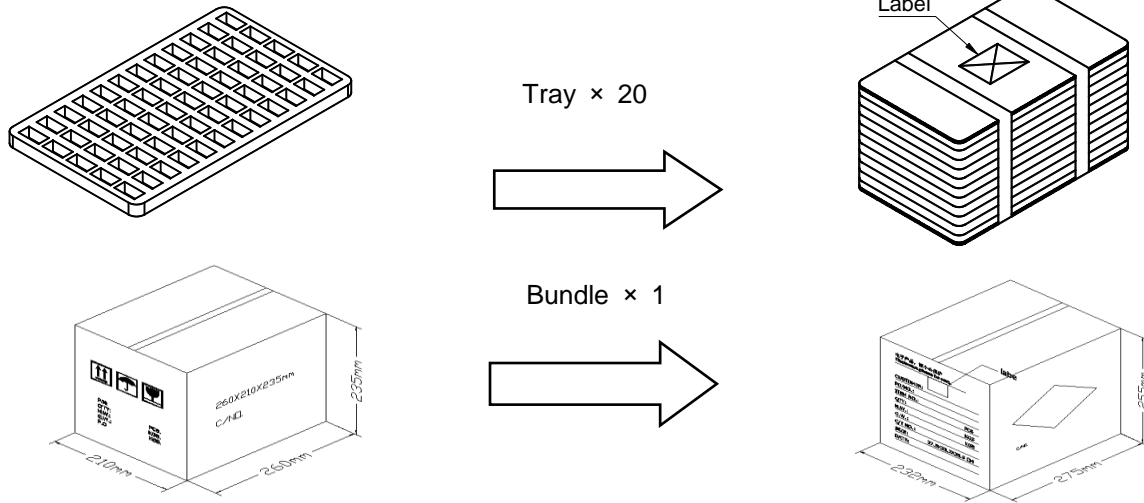

7.2 Carton dimensions and packing quantity

包装箱尺寸和包装数量

■ Inner Carton : 260×210×235mm
内包装盒

■ Out Carton : 275×232×255mm
外包装箱

Product Series 产品系列	Quantity / Tray 数量 / 盘	Inner Carton Quantity 内盒 包装数量	Out Carton Quantity 外箱 包装总数量
PKS0606	140pcs	(140×20) = 2800pcs	(2800×1) = 2800pcs

7.3 Label making

标签标识

The following items will be marked on the bag of product label and shipping label.
以下项目将明确标识于产品包装袋标签以及运输标签上。

Production Label 产品标签

- Part No.
产品型号
- Electrical Information
产品电性信息
- Quantity
数量
- Packing No.
包装流水号

Shipping Label 运输标签

- Customer Name
客户名称
- Customer Part No.
客户型号
- Supplier Part No.
供应商型号
- Supplier Name
供应商名称
- Country of origin
产品产地