

NOTES:

1. MATERIAL:

A. CDA 260 BRASS, .008/(0.20) THICK.

B. CDA 510 PHOS. BRONZE .008/(0.20) THICK.

2. PLATING:

.000100/(.00254) MIN. TIN OVER .000050/(.00127) MIN. NICKEL (POST-PLATE).

3. PART DESIGNED IN METRIC.

4 THE NUMBER OF SERRATIONS TO BE ONE FOR WIRE RANGE 22-28.

5 MEASURING POINT FOR PLATING THICKNESS.

6. TERMINAL IS FOR USE WITH MOLEX PLUG HOUSINGS 5559, 30068, AND 42475.

7. PRODUCT SPECIFICATION: PS-5556-001, PS-5556-002, PS-5556-003

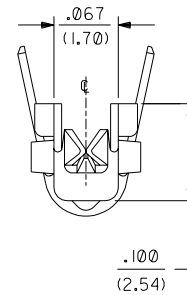
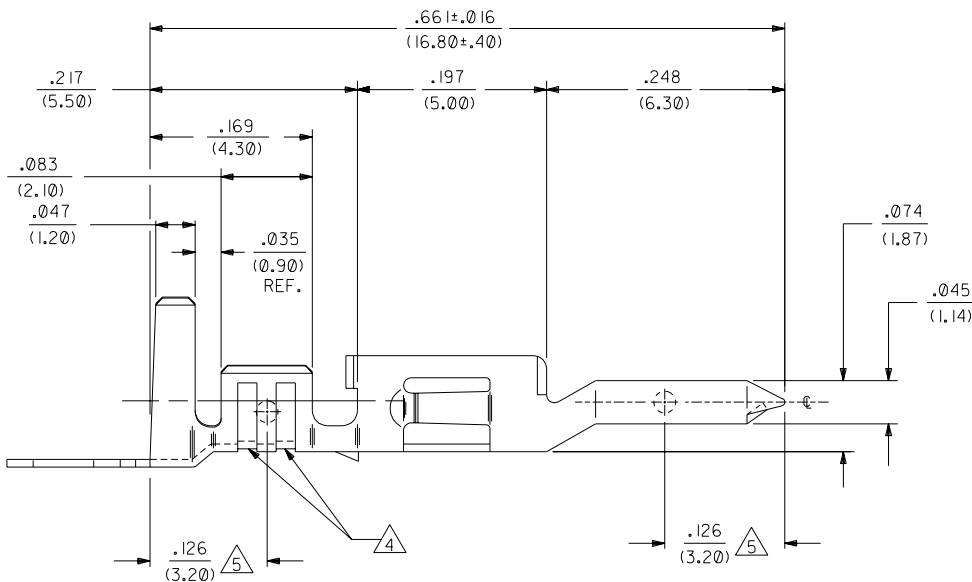
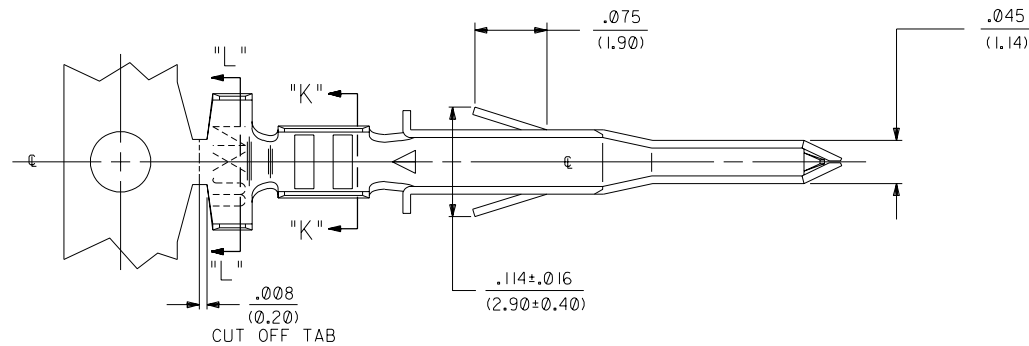
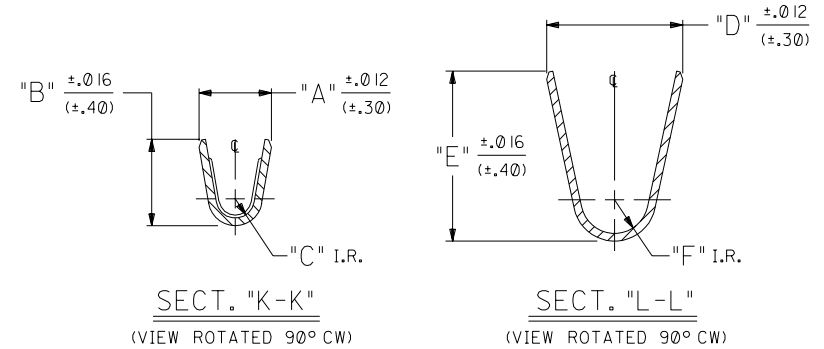

DIMENSIONS SHOWN (METRIC) INCH	
UNLESS OTHERWISE SPECIFIED TOLERANCES: ANGULAR ± 1/2°	
3 PLACE ± .010	METRIC ---
2 PLACE ± .015	± .25
1 PLACE ---	± .38
DRAFT WHERE APPLICABLE MUST REMAIN WITHIN DIMENSIONS	
DRWG. BY: RJF	CHK'D. BY: GEP
APP'D. BY: RAS	SCALE: 10:1

▽ = 0	▽ = 0	REVISE ONLY ON CAD SYSTEM	
TITLE: MALE CRIMP TERMINAL WITH TIN OVER NICKEL POSTPLATE (MINI-FIT JR. SERIES)			
PART NO. SEE SHT. 2		DRWG. NO. SD-5558-S*	
MFG. SH. REV. LTR. REVISIONS		SHEET NO. DATE	
2	B	1	5/12/92
1	C	1	9-3-92
MOLEX INCORPORATED		U.S.A.	
LITSE,ILL. 60532		1 OF 2	
THIS DRAWING CONTAINS INFORMATION THAT IS PROPRIETARY TO MOLEX INC. AND SHOULD NOT BE USED WITHOUT WRITTEN PERMISSION.			

C	ADD. PS NOTE UCP2003-0385 8/30/2002 SAMIEC
B	REV 28-30 GA. DIM ECN #140405 94-04-06 A.GUJZIK
A2	ADDED EDP'S PER ECN U21527 GEP 10-15-92 RJF
A1	REVISED 28-30 AWG ECN U21318 9-3-92 RJF
A	FINAL RELEASE PER ECN U20768 6-12-92 RJF

5558

		13	12	11	10	9	8	7	6	5558	4	3	2	1		
J		PART NO.	ENG. NO.	FORM	MAT'L.	WIRE GAGE	RANGE OF INSULATION DIA.	QUANTITY PER REEL (FORMED)	DIM. "A"	DIM. "B"	DIM. "C"	DIM. "D"	DIM. "E"	DIM. "F"		
J		39-00-0120	5558-S	CHAIN	A	18-24 GA.	.051-.122	4,000	.075	.091	.020	.142	.177	.035		
		39-00-0121	5558-SL	LOOSE			(1.30-3.10)		(1.90)	(2.30)	(1.50)	(3.60)	(4.50)	(.90)		
		39-00-0122	5558-S2	CHAIN			22-28 GA.		.035-.071	6,000	.071	.065	.016	.091	.024	
	39-00-0123	5558-S2L	LOOSE	(.90-1.80)		(1.80)		(1.65)	(.40)		(2.30)	(2.30)	(.60)			
	39-00-0124	5558-S3	CHAIN	16 GA.		.122		4,000	.091		.106	.024	.142	.177	.035	
	39-00-0125	5558-S3L	LOOSE			(3.10) MAX.	(2.30)		(2.70)	(.60)	(3.60)	(4.50)	(.90)			
	NOT TOOLED	5558-S4	CHAIN		14 GA.	.122	4,000		.091	.114	.024	.142	.177	.035		
	NOT TOOLED	5558-S4L	LOOSE	(3.10) MAX.		(2.30)		(2.90)	(.60)	(3.60)	(4.50)	(.90)				
	39-00-0259	5558-S5	CHAIN	28-30 GA.		.020-.035		6,000	.050	.044	.010	.091	.024			
	39-00-0260	5558-S5L	LOOSE		(.50-.90)	(1.27)	(1.12)		(.25)	(2.30)	(2.30)	(.60)				
	39-00-0126	5558-PBS	CHAIN		B	18-24 GA.	.051-.122		4,000	.075	.091	.020	.142	.177	.035	
	39-00-0127	5558-PBSL	LOOSE	(1.30-3.10)			(1.90)	(2.30)		(1.50)	(3.60)	(4.50)	(.90)			
	39-00-0128	5558-PBS2	CHAIN	22-28 GA.			.035-.071	6,000		.071	.065	.016	.091	.024		
	39-00-0129	5558-PBS2L	LOOSE			(.90-1.80)	(1.80)		(1.65)	(.40)	(2.30)	(2.30)	(.60)			
	39-00-0130	5558-PBS3	CHAIN			16 GA.	.122		4,000	.091	.106	.024	.142	.177	.035	
	39-00-0131	5558-PBS3L	LOOSE	(3.10) MAX.			(2.30)	(2.70)		(.60)	(3.60)	(4.50)	(.90)			
	NOT TOOLED	5558-PBS4	CHAIN	14 GA.	.122		4,000	.091		.114	.024	.142	.177	.035		
	NOT TOOLED	5558-PBS4L	LOOSE		(3.10) MAX.	(2.30)		(2.90)	(.60)	(3.60)	(4.50)	(.90)				
	39-00-0263	5558-PBS5	CHAIN		28-30 GA.	.020-.035		6,000	.050	.044	.010	.091	.024			
	39-00-0264	5558-PBS5L	LOOSE	(.50-.90)		(1.27)	(1.12)		(.25)	(2.30)	(2.30)	(.60)				
F																
E																
D																
C																
B																
A																

LEGEND:

5558-**S**

- BASE NO. _____
- MATERIAL _____
- BLANK= BRASS
- PB= PHOS. BRONZE
- S= TIN OVER NICKEL
- CRIMP SIZE _____
- BLANK = 18-24 AWG
- 2 = 22-28 AWG
- 3 = 16 AWG
- 4 = 14 AWG
- 5 = 28-30 AWG
- CHAIN OR LOOSE _____
- BLANK= CHAIN
- L= LOOSE

5558

B	SEE SHEET L
A2	SEE SHEET L
A1	SEE SHEET L
A	SEE SHEET L

DIMENSIONS SHOWN (METRIC) INCH		▽ = 0		▽ = 0		REVISE ONLY ON CAD SYSTEM	
UNLESS OTHERWISE SPECIFIED TOLERANCES ANGULAR ± 1/2°							
INCH		METRIC		TITLE			
3 PLACE	± .001	---	---	MALE CRIMP TERMINAL WITH TIN OVER NICKEL POSTPLATE (MINI-FIT JR. SERIES)			
2 PLACE	± .005	±	---	MOLEX INCORPORATED			
1 PLACE	± .010	±	---	LITTLE, J.L.L.			
DRAFT WHERE APPLICABLE MUST REMAIN WITHIN DIMENSIONS				SHEET NO. 2		DATE 5/12/92	
DRWG. NO. 60532		PART NO. SD-5558-S*		DRAWING NO.			
DRWG. BY: RJF	CHK'D BY: GEP	FILE NAME: 5558SX2		THIS DRAWING CONTAINS INFORMATION THAT IS PROPRIETARY TO MOLEX INC. AND SHOULD NOT BE USED WITHOUT WRITTEN PERMISSION.		DIN. SIZE CP C	
APP'D BY: RAS	SCALE: --	SEE CHART.					