

TS-HC Series 105°C, 2000 hours

- Long life with high capacitance (30% smaller than HB series)
- 2 and 3 pin versions available
- RoHS compliant PVC and RoHS compliant PET sleeve options



| | | |
|---------------------------------------------------------------------------------------------------------------|------------------------------------------------------------------------|----------------------------------------------------------|
| Rated Working Voltage: | 10 ~ 250 VDC | 350 ~ 450 VDC |
| Operating Temperature: | -40 ~ +105°C | -25 ~ +105°C |
| Nominal Capacitance: | 270 ~ 100000µF | 100 ~ 1000µF |
| Capacitance Tolerance: | ± 20% | |
| Dissipation Factor: (120 Hz, +20°C) | Working Voltage [V]: | 10 16 25 35 50 63 80 100 ~ 450 |
| | Max. D.F. (%): | 55 45 35 30 25 20 17 15 |
| For capacitance values > 33000µF, add the value of: $\frac{(\text{rated cap. } [\mu\text{F}] - 33000)}{1000}$ | | |
| Leakage Current: | 3√CV (µA) max. after 5 minutes; C = Capacitance in µF, V = WV | |
| Ripple Current Multipliers: | Frequency(Hz): | 50 60 100~120 500 1k 10k |
| | 16~100WV: | 0.93 0.95 1.0 1.05 1.08 1.15 |
| | 160~450WV: | 0.75 0.8 1.0 1.2 1.25 1.4 |
| | | Ripple Current Ambient Temperature Factors* |
| | | Temperature (°C): 105°C 85°C 70°C 60°C ≤45°C |
| | | Multiplier: 1.0 1.7 2.0 2.2 2.35 |
| Endurance: | 2000 hours at +105°C with maximum specified ripple current (see page4) | |

*Use of temperature ripple current multipliers may limit life to the hours specified for the maximum operating temperature.

Part Number System

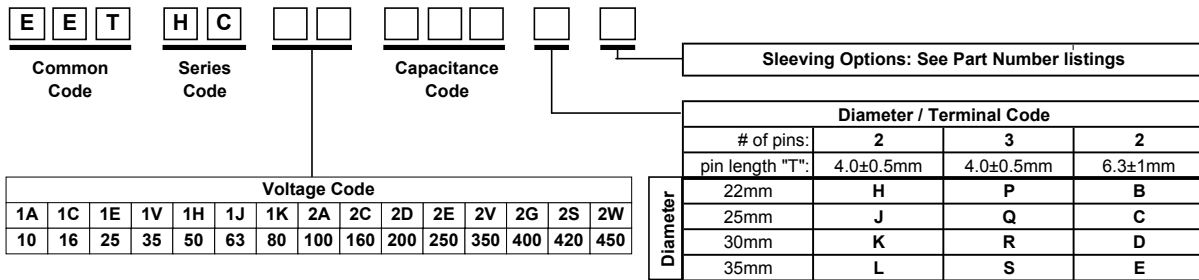

Dimensions in millimeters

2 Pin Mounting Style

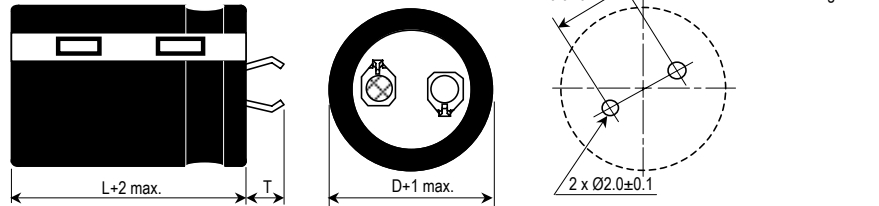

3 Pin Mounting Style

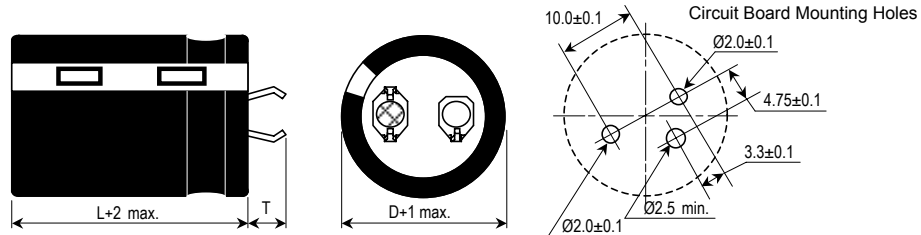

Pin Dimensions

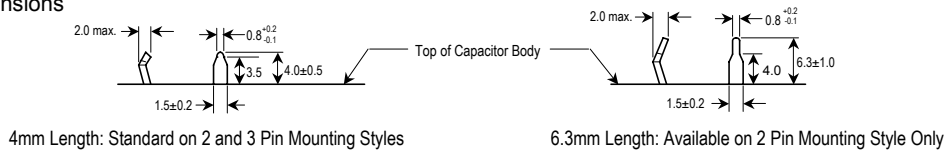

Design and specifications are subject to change without notice.

Contact the factory or your sales representative for technical specifications before purchase and/or use. When safety concerns arise, please contact Panasonic immediately for technical consultation.

TS-HC Standard Ratings

Part numbers shown with 2 pins and 4.0mm length terminals

| Cap. (μ F) | Size (mm) D x L | Max 105°C R.C. (A_{rms}) | | 20°C ESR (Ω , max.) | | Panasonic Part Number (By Sleeve Style) | |
|-------------------------------------|--------------------|------------------------------|--------|-----------------------------|-------|-----------------------------------------|-----------------------|
| | | 120Hz | 10kHz~ | 120Hz | 20kHz | PVC with Top Plate | PET without Top Plate |
| 10 VDC Working, 13 VDC Surge | | | | | | | |
| 12000 | 22 x 25 | 2.20 | 2.53 | 0.076 | 0.065 | EETHC1A123HA | EETHC1A123HJ |
| 18000 | 22 x 30 | 2.40 | 2.76 | 0.051 | 0.043 | EETHC1A183HA | EETHC1A183HJ |
| | 25 x 25 | 2.40 | 2.76 | 0.051 | 0.043 | EETHC1A183JA | EETHC1A183JJ |
| 22000 | 22 x 35 | 2.60 | 2.99 | 0.041 | 0.035 | EETHC1A223HA | EETHC1A223HJ |
| | 25 x 30 | 2.60 | 2.99 | 0.041 | 0.035 | EETHC1A223JA | EETHC1A223JJ |
| 27000 | 22 x 40 | 3.10 | 3.57 | 0.034 | 0.029 | EETHC1A273HA | EETHC1A273HJ |
| | 25 x 35 | 3.10 | 3.57 | 0.034 | 0.029 | EETHC1A273JA | EETHC1A273JJ |
| | 30 x 25 | 3.10 | 3.57 | 0.034 | 0.029 | EETHC1A273KA | EETHC1A273KJ |
| 33000 | 22 x 45 | 3.40 | 3.91 | 0.028 | 0.023 | EETHC1A333HA | EETHC1A333HJ |
| | 25 x 40 | 3.40 | 3.91 | 0.028 | 0.023 | EETHC1A333JA | EETHC1A333JJ |
| 39000 | 25 x 45 | 3.70 | 4.26 | 0.026 | 0.022 | EETHC1A393JA | EETHC1A393JJ |
| | 30 x 30 | 3.70 | 4.26 | 0.026 | 0.023 | EETHC1A393KA | EETHC1A393KJ |
| | 35 x 25 | 3.70 | 4.26 | 0.026 | 0.022 | EETHC1A393LA | EETHC1A393LJ |
| 47000 | 25 x 50 | 4.20 | 4.83 | 0.024 | 0.021 | EETHC1A473JA | EETHC1A473JJ |
| | 30 x 35 | 4.20 | 4.83 | 0.024 | 0.022 | EETHC1A473KA | EETHC1A473KJ |
| | 35 x 30 | 4.20 | 4.83 | 0.024 | 0.021 | EETHC1A473LA | EETHC1A473LJ |
| 56000 | 30 x 40 | 5.00 | 5.75 | 0.023 | 0.021 | EETHC1A563KA | EETHC1A563KJ |
| | 35 x 35 | 5.00 | 5.75 | 0.023 | 0.020 | EETHC1A563LA | EETHC1A563LJ |
| 68000 | 30 x 45 | 5.40 | 6.21 | 0.022 | 0.020 | EETHC1A683KA | EETHC1A683KJ |
| | 35 x 40 | 5.40 | 6.21 | 0.022 | 0.019 | EETHC1A683LA | EETHC1A683LJ |
| 82000 | 35 x 45 | 6.10 | 7.02 | 0.021 | 0.019 | EETHC1A823LA | EETHC1A823LJ |
| 100000 | 35 x 50 | 6.90 | 7.94 | 0.020 | 0.019 | EETHC1A104LA | EETHC1A104LJ |
| 16 VDC Working, 20 VDC Surge | | | | | | | |
| 10000 | 22 x 25 | 2.60 | 2.99 | 0.075 | 0.063 | EETHC1C103HA | EETHC1C103HJ |
| 12000 | 22 x 30 | 2.90 | 3.34 | 0.062 | 0.053 | EETHC1C123HA | EETHC1C123HJ |
| | 25 x 25 | 2.90 | 3.34 | 0.062 | 0.053 | EETHC1C123JA | EETHC1C123JJ |
| 15000 | 22 x 35 | 3.20 | 3.68 | 0.050 | 0.042 | EETHC1C153HA | EETHC1C153HJ |
| 18000 | 22 x 40 | 3.50 | 4.03 | 0.041 | 0.035 | EETHC1C183HA | EETHC1C183HJ |
| | 25 x 30 | 3.50 | 4.03 | 0.041 | 0.035 | EETHC1C183JA | EETHC1C183JJ |
| 22000 | 22 x 45 | 3.80 | 4.37 | 0.034 | 0.029 | EETHC1C223HA | EETHC1C223HJ |
| | 25 x 35 | 3.80 | 4.37 | 0.034 | 0.029 | EETHC1C223JA | EETHC1C223JJ |
| | 30 x 25 | 3.80 | 4.37 | 0.034 | 0.029 | EETHC1C223KA | EETHC1C223KJ |
| 27000 | 22 x 50 | 4.20 | 4.83 | 0.028 | 0.023 | EETHC1C273HA | EETHC1C273HJ |
| | 25 x 40 | 4.20 | 4.83 | 0.028 | 0.023 | EETHC1C273JA | EETHC1C273JJ |
| | 30 x 30 | 4.20 | 4.83 | 0.028 | 0.023 | EETHC1C273KA | EETHC1C273KJ |
| | 35 x 25 | 4.20 | 4.83 | 0.028 | 0.023 | EETHC1C273LA | EETHC1C273LJ |
| 33000 | 25 x 45 | 4.70 | 5.41 | 0.023 | 0.019 | EETHC1C333JA | EETHC1C333JJ |
| | 30 x 35 | 4.70 | 5.41 | 0.023 | 0.019 | EETHC1C333KA | EETHC1C333KJ |
| | 35 x 30 | 4.70 | 5.41 | 0.023 | 0.020 | EETHC1C333LA | EETHC1C333LJ |
| 39000 | 30 x 40 | 5.10 | 5.87 | 0.022 | 0.018 | EETHC1C393KA | EETHC1C393KJ |
| | 35 x 35 | 5.10 | 5.87 | 0.022 | 0.020 | EETHC1C393LA | EETHC1C393LJ |
| 47000 | 30 x 45 | 5.50 | 6.33 | 0.016 | 0.014 | EETHC1C473KA | EETHC1C473KJ |
| | 35 x 40 | 5.50 | 6.33 | 0.021 | 0.019 | EETHC1C473LA | EETHC1C473LJ |
| 56000 | 30 x 50 | 6.00 | 6.90 | 0.020 | 0.018 | EETHC1C563KA | EETHC1C563KJ |
| | 35 x 45 | 6.00 | 6.90 | 0.020 | 0.018 | EETHC1C563LA | EETHC1C563LJ |
| 25 VDC Working, 32 VDC Surge | | | | | | | |
| 6800 | 22 x 25 | 2.40 | 2.76 | 0.085 | 0.064 | EETHC1E682HA | EETHC1E682HJ |
| 8200 | 22 x 30 | 2.70 | 3.11 | 0.071 | 0.053 | EETHC1E822HA | EETHC1E822HJ |
| | 25 x 25 | 2.70 | 3.11 | 0.071 | 0.053 | EETHC1E822JA | EETHC1E822JJ |
| 10000 | 22 x 35 | 3.00 | 3.45 | 0.058 | 0.044 | EETHC1E103HA | EETHC1E103HJ |
| 12000 | 22 x 40 | 3.20 | 3.68 | 0.048 | 0.036 | EETHC1E123HA | EETHC1E123HJ |
| | 25 x 30 | 3.20 | 3.68 | 0.048 | 0.036 | EETHC1E123JA | EETHC1E123JJ |
| 15000 | 22 x 45 | 3.60 | 4.14 | 0.039 | 0.029 | EETHC1E153HA | EETHC1E153HJ |
| | 25 x 35 | 3.60 | 4.14 | 0.039 | 0.029 | EETHC1E153JA | EETHC1E153JJ |
| | 30 x 25 | 3.60 | 4.14 | 0.039 | 0.029 | EETHC1E153KA | EETHC1E153KJ |
| 18000 | 22 x 50 | 3.90 | 4.49 | 0.032 | 0.024 | EETHC1E183HA | EETHC1E183HJ |
| | 25 x 40 | 3.90 | 4.49 | 0.032 | 0.024 | EETHC1E183JA | EETHC1E183JJ |
| | 30 x 30 | 3.90 | 4.49 | 0.032 | 0.024 | EETHC1E183KA | EETHC1E183KJ |
| | 35 x 25 | 3.90 | 4.49 | 0.032 | 0.024 | EETHC1E183LA | EETHC1E183LJ |
| 22000 | 25 x 45 | 4.30 | 4.95 | 0.026 | 0.020 | EETHC1E223JA | EETHC1E223JJ |
| | 30 x 35 | 4.30 | 4.95 | 0.026 | 0.020 | EETHC1E223KA | EETHC1E223KJ |
| | 35 x 30 | 4.30 | 4.95 | 0.026 | 0.020 | EETHC1E223LA | EETHC1E223LJ |
| 27000 | 30 x 40 | 4.80 | 5.52 | 0.021 | 0.016 | EETHC1E273KA | EETHC1E273KJ |

Design and specifications are subject to change without notice.

Contact the factory or your sales representative for technical specifications before purchase and/or use.

When safety concerns arise, please contact Panasonic immediately for technical consultation.

TS-HC Standard Ratings (continued)

Part numbers shown with 2 pins and 4.0mm length terminals

| Cap. (μF) | Size (mm) D x L | Max 105°C R.C. (A_{rms}) | | 20°C ESR (Ω , max.) | | Panasonic Part Number (By Sleeve Style) | |
|-------------------------------------------------|--------------------|-------------------------------------|--------|-----------------------------|-------|-----------------------------------------|-----------------------|
| | | 120Hz | 10kHz~ | 120Hz | 20kHz | PVC with Top Plate | PET without Top Plate |
| 25 VDC Working, 32 VDC Surge (continued) | | | | | | | |
| 27000 | 35 x 35 | 4.80 | 5.52 | 0.021 | 0.016 | EETHC1E273LA | EETHC1E273LJ |
| 33000 | 30 x 45 | 5.50 | 6.33 | 0.018 | 0.013 | EETHC1E333KA | EETHC1E333KJ |
| | 35 x 40 | 5.50 | 6.33 | 0.018 | 0.014 | EETHC1E333LA | EETHC1E333LJ |
| 39000 | 30 x 50 | 5.80 | 6.67 | 0.017 | 0.013 | EETHC1E393KA | EETHC1E393KJ |
| | 35 x 45 | 5.80 | 6.67 | 0.017 | 0.014 | EETHC1E393LA | EETHC1E393LJ |
| 47000 | 35 x 50 | 6.30 | 7.25 | 0.017 | 0.014 | EETHC1E473LA | EETHC1E473LJ |
| 35 VDC Working, 44 VDC Surge | | | | | | | |
| 4700 | 22 x 25 | 2.20 | 2.53 | 0.106 | 0.079 | EETHC1V472HA | EETHC1V472HJ |
| 5600 | 22 x 30 | 2.40 | 2.76 | 0.089 | 0.067 | EETHC1V562HA | EETHC1V562HJ |
| | 25 x 25 | 2.40 | 2.76 | 0.089 | 0.067 | EETHC1V562JA | EETHC1V562JJ |
| 6800 | 22 x 35 | 2.60 | 2.99 | 0.073 | 0.055 | EETHC1V682HA | EETHC1V682HJ |
| 8200 | 22 x 40 | 2.90 | 3.34 | 0.061 | 0.045 | EETHC1V822HA | EETHC1V822HJ |
| | 25 x 30 | 2.90 | 3.34 | 0.061 | 0.045 | EETHC1V822JA | EETHC1V822JJ |
| 10000 | 22 x 45 | 3.20 | 3.68 | 0.050 | 0.037 | EETHC1V103HA | EETHC1V103HJ |
| | 25 x 35 | 3.20 | 3.68 | 0.050 | 0.037 | EETHC1V103JA | EETHC1V103JJ |
| | 30 x 25 | 3.20 | 3.68 | 0.050 | 0.037 | EETHC1V103KA | EETHC1V103KJ |
| 12000 | 25 x 40 | 3.50 | 4.03 | 0.041 | 0.031 | EETHC1V123JA | EETHC1V123JJ |
| | 30 x 30 | 3.50 | 4.03 | 0.041 | 0.031 | EETHC1V123KA | EETHC1V123KJ |
| | 35 x 25 | 3.50 | 4.03 | 0.041 | 0.031 | EETHC1V123LA | EETHC1V123LJ |
| 15000 | 25 x 45 | 3.90 | 4.49 | 0.033 | 0.025 | EETHC1V153JA | EETHC1V153JJ |
| | 30 x 35 | 3.90 | 4.49 | 0.033 | 0.025 | EETHC1V153KA | EETHC1V153KJ |
| | 35 x 30 | 3.90 | 4.49 | 0.033 | 0.025 | EETHC1V153LA | EETHC1V153LJ |
| 18000 | 30 x 40 | 4.30 | 4.95 | 0.028 | 0.021 | EETHC1V183KA | EETHC1V183KJ |
| | 35 x 35 | 4.30 | 4.95 | 0.028 | 0.021 | EETHC1V183LA | EETHC1V183LJ |
| 22000 | 30 x 45 | 5.00 | 5.75 | 0.023 | 0.017 | EETHC1V223KA | EETHC1V223KJ |
| | 35 x 40 | 5.00 | 5.75 | 0.023 | 0.017 | EETHC1V223LA | EETHC1V223LJ |
| 27000 | 30 x 50 | 5.30 | 6.10 | 0.018 | 0.014 | EETHC1V273KA | EETHC1V273KJ |
| | 35 x 45 | 5.30 | 6.10 | 0.018 | 0.014 | EETHC1V273LA | EETHC1V273LJ |
| 33000 | 35 x 50 | 5.90 | 6.79 | 0.015 | 0.012 | EETHC1V333LA | EETHC1V333LJ |
| 50 VDC Working, 63 VDC Surge | | | | | | | |
| 2700 | 22 x 25 | 1.80 | 2.07 | 0.154 | 0.115 | EETHC1H272HA | EETHC1H272HJ |
| 3300 | 22 x 30 | 2.00 | 2.30 | 0.126 | 0.094 | EETHC1H332HA | EETHC1H332HJ |
| 3900 | 22 x 35 | 2.20 | 2.53 | 0.106 | 0.080 | EETHC1H392HA | EETHC1H392HJ |
| | 25 x 25 | 2.20 | 2.53 | 0.106 | 0.080 | EETHC1H392JA | EETHC1H392JJ |
| 4700 | 22 x 40 | 2.50 | 2.88 | 0.088 | 0.066 | EETHC1H472HA | EETHC1H472HJ |
| | 25 x 30 | 2.50 | 2.88 | 0.088 | 0.066 | EETHC1H472JA | EETHC1H472JJ |
| 5600 | 22 x 45 | 2.80 | 3.22 | 0.074 | 0.056 | EETHC1H562HA | EETHC1H562HJ |
| | 25 x 35 | 2.80 | 3.22 | 0.074 | 0.056 | EETHC1H562JA | EETHC1H562JJ |
| | 30 x 25 | 2.80 | 3.22 | 0.074 | 0.056 | EETHC1H562KA | EETHC1H562KJ |
| 6800 | 22 x 50 | 3.30 | 3.80 | 0.061 | 0.046 | EETHC1H682HA | EETHC1H682HJ |
| | 25 x 40 | 3.30 | 3.80 | 0.061 | 0.046 | EETHC1H682JA | EETHC1H682JJ |
| | 30 x 30 | 3.30 | 3.80 | 0.061 | 0.046 | EETHC1H682KA | EETHC1H682KJ |
| | 35 x 25 | 3.30 | 3.80 | 0.061 | 0.046 | EETHC1H682LA | EETHC1H682LJ |
| 8200 | 25 x 45 | 3.60 | 4.14 | 0.051 | 0.038 | EETHC1H822JA | EETHC1H822JJ |
| | 30 x 35 | 3.60 | 4.14 | 0.051 | 0.038 | EETHC1H822KA | EETHC1H822KJ |
| 10000 | 25 x 50 | 4.00 | 4.60 | 0.041 | 0.031 | EETHC1H103JA | EETHC1H103JJ |
| | 30 x 40 | 4.00 | 4.60 | 0.041 | 0.031 | EETHC1H103KA | EETHC1H103KJ |
| | 35 x 30 | 4.00 | 4.60 | 0.041 | 0.031 | EETHC1H103LA | EETHC1H103LJ |
| 12000 | 30 x 45 | 4.50 | 5.18 | 0.035 | 0.026 | EETHC1H123KA | EETHC1H123KJ |
| | 35 x 35 | 4.50 | 5.18 | 0.035 | 0.028 | EETHC1H123LA | EETHC1H123LJ |
| 15000 | 30 x 50 | 4.80 | 5.52 | 0.028 | 0.021 | EETHC1H153KA | EETHC1H153KJ |
| | 35 x 40 | 4.80 | 5.52 | 0.028 | 0.022 | EETHC1H153LA | EETHC1H153LJ |
| 18000 | 35 x 45 | 5.60 | 6.44 | 0.023 | 0.018 | EETHC1H183LA | EETHC1H183LJ |
| 63 VDC Working, 79 VDC Surge | | | | | | | |
| 2200 | 22 x 25 | 2.00 | 2.30 | 0.151 | 0.113 | EETHC1J222HA | EETHC1J222HJ |
| 2700 | 22 x 30 | 2.20 | 2.53 | 0.123 | 0.092 | EETHC1J272HA | EETHC1J272HJ |
| | 25 x 25 | 2.20 | 2.53 | 0.123 | 0.092 | EETHC1J272JA | EETHC1J272JJ |
| 3300 | 22 x 35 | 2.50 | 2.88 | 0.100 | 0.075 | EETHC1J332HA | EETHC1J332HJ |
| 3900 | 22 x 40 | 2.70 | 3.11 | 0.085 | 0.064 | EETHC1J392HA | EETHC1J392HJ |
| | 25 x 30 | 2.70 | 3.11 | 0.085 | 0.064 | EETHC1J392JA | EETHC1J392JJ |
| | 30 x 25 | 2.70 | 3.11 | 0.085 | 0.064 | EETHC1J392KA | EETHC1J392KJ |
| 4700 | 22 x 45 | 3.00 | 3.45 | 0.071 | 0.053 | EETHC1J472HA | EETHC1J472HJ |
| | 25 x 35 | 3.00 | 3.45 | 0.071 | 0.053 | EETHC1J472JA | EETHC1J472JJ |
| 5600 | 22 x 50 | 3.30 | 3.80 | 0.059 | 0.044 | EETHC1J562HA | EETHC1J562HJ |

Design and specifications are subject to change without notice.

Contact the factory or your sales representative for technical specifications before purchase and/or use.

When safety concerns arise, please contact Panasonic immediately for technical consultation.

TS-HC Standard Ratings (continued)

Part numbers shown with 2 pins and 4.0mm length terminals

| Cap. (μ F) | Size (mm) D x L | Max 105°C R.C. (A_{rms}) | | 20°C ESR (Ω , max.) | | Panasonic Part Number (By Sleeve Style) | |
|-------------------------------------------------|--------------------|------------------------------|--------|-----------------------------|-------|-----------------------------------------|-----------------------|
| | | 120Hz | 10kHz~ | 120Hz | 20kHz | PVC with Top Plate | PET without Top Plate |
| 63 VDC Working, 79 VDC Surge (continued) | | | | | | | |
| 5600 | 25 x 40 | 3.30 | 3.80 | 0.059 | 0.044 | EETHC1J562JA | EETHC1J562JJ |
| | 30 x 30 | 3.30 | 3.80 | 0.059 | 0.044 | EETHC1J562KA | EETHC1J562KJ |
| | 35 x 25 | 3.30 | 3.80 | 0.059 | 0.044 | EETHC1J562LA | EETHC1J562LJ |
| 6800 | 25 x 45 | 3.60 | 4.14 | 0.049 | 0.037 | EETHC1J682JA | EETHC1J682JJ |
| | 30 x 35 | 3.60 | 4.14 | 0.049 | 0.037 | EETHC1J682KA | EETHC1J682KJ |
| | 35 x 30 | 3.60 | 4.14 | 0.049 | 0.037 | EETHC1J682LA | EETHC1J682LJ |
| 8200 | 30 x 40 | 3.90 | 4.49 | 0.040 | 0.030 | EETHC1J822KA | EETHC1J822KJ |
| | 35 x 35 | 3.90 | 4.49 | 0.040 | 0.030 | EETHC1J822LA | EETHC1J822LJ |
| 10000 | 30 x 45 | 4.40 | 5.06 | 0.033 | 0.025 | EETHC1J103KA | EETHC1J103KJ |
| | 35 x 40 | 4.40 | 5.06 | 0.033 | 0.025 | EETHC1J103LA | EETHC1J103LJ |
| 12000 | 30 x 50 | 4.80 | 5.52 | 0.028 | 0.021 | EETHC1J123KA | EETHC1J123KJ |
| | 35 x 45 | 4.80 | 5.52 | 0.028 | 0.022 | EETHC1J123LA | EETHC1J123LJ |
| 15000 | 35 x 50 | 5.40 | 6.21 | 0.022 | 0.018 | EETHC1J153LA | EETHC1J153LJ |
| 80 VDC Working, 100 VDC Surge | | | | | | | |
| 1200 | 22 x 25 | 1.50 | 1.73 | 0.235 | 0.176 | EETHC1K122HA | EETHC1K122HJ |
| 1500 | 22 x 30 | 1.70 | 1.96 | 0.188 | 0.141 | EETHC1K152HA | EETHC1K152HJ |
| | 25 x 25 | 1.70 | 1.96 | 0.188 | 0.141 | EETHC1K152JA | EETHC1K152JJ |
| 1800 | 22 x 35 | 1.80 | 2.07 | 0.157 | 0.117 | EETHC1K182HA | EETHC1K182HJ |
| 2200 | 22 x 40 | 2.10 | 2.42 | 0.128 | 0.096 | EETHC1K222HA | EETHC1K222HJ |
| | 25 x 30 | 2.10 | 2.42 | 0.128 | 0.096 | EETHC1K222JA | EETHC1K222JJ |
| 2700 | 22 x 45 | 2.40 | 2.76 | 0.104 | 0.078 | EETHC1K272HA | EETHC1K272HJ |
| | 25 x 35 | 2.40 | 2.76 | 0.104 | 0.078 | EETHC1K272JA | EETHC1K272JJ |
| | 30 x 25 | 2.40 | 2.76 | 0.104 | 0.078 | EETHC1K272KA | EETHC1K272KJ |
| 3300 | 22 x 50 | 2.60 | 2.99 | 0.085 | 0.064 | EETHC1K332HA | EETHC1K332HJ |
| | 25 x 40 | 2.60 | 2.99 | 0.085 | 0.064 | EETHC1K332JA | EETHC1K332JJ |
| | 30 x 30 | 2.60 | 2.99 | 0.085 | 0.064 | EETHC1K332KA | EETHC1K332KJ |
| | 35 x 25 | 2.60 | 2.99 | 0.085 | 0.064 | EETHC1K332LA | EETHC1K332LJ |
| 3900 | 25 x 45 | 3.00 | 3.45 | 0.072 | 0.054 | EETHC1K392JA | EETHC1K392JJ |
| | 30 x 35 | 3.00 | 3.45 | 0.072 | 0.054 | EETHC1K392KA | EETHC1K392KJ |
| 4700 | 25 x 50 | 3.30 | 3.80 | 0.060 | 0.045 | EETHC1K472JA | EETHC1K472JJ |
| | 30 x 40 | 3.30 | 3.80 | 0.060 | 0.045 | EETHC1K472KA | EETHC1K472KJ |
| | 35 x 30 | 3.30 | 3.80 | 0.060 | 0.045 | EETHC1K472LA | EETHC1K472LJ |
| 5600 | 30 x 45 | 3.70 | 4.26 | 0.050 | 0.038 | EETHC1K562KA | EETHC1K562KJ |
| | 35 x 35 | 3.70 | 4.26 | 0.050 | 0.038 | EETHC1K562LA | EETHC1K562LJ |
| 6800 | 30 x 50 | 3.90 | 4.49 | 0.041 | 0.031 | EETHC1K682KA | EETHC1K682KJ |
| | 35 x 40 | 3.90 | 4.49 | 0.041 | 0.032 | EETHC1K682LA | EETHC1K682LJ |
| 8200 | 35 x 45 | 4.50 | 5.18 | 0.034 | 0.027 | EETHC1K822LA | EETHC1K822LJ |
| 100 VDC Working, 125 VDC Surge | | | | | | | |
| 820 | 22 x 25 | 1.40 | 1.61 | 0.303 | 0.197 | EETHC2A821HA | EETHC2A821HJ |
| 1200 | 22 x 30 | 1.80 | 2.07 | 0.207 | 0.135 | EETHC2A122HA | EETHC2A122HJ |
| | 25 x 25 | 1.80 | 2.07 | 0.207 | 0.135 | EETHC2A122JA | EETHC2A122JJ |
| 1500 | 22 x 35 | 2.10 | 2.42 | 0.166 | 0.108 | EETHC2A152HA | EETHC2A152HJ |
| | 25 x 30 | 2.10 | 2.42 | 0.166 | 0.108 | EETHC2A152JA | EETHC2A152JJ |
| 1800 | 22 x 40 | 2.30 | 2.65 | 0.138 | 0.090 | EETHC2A182HA | EETHC2A182HJ |
| | 25 x 35 | 2.30 | 2.65 | 0.138 | 0.090 | EETHC2A182JA | EETHC2A182JJ |
| | 30 x 25 | 2.30 | 2.65 | 0.138 | 0.090 | EETHC2A182KA | EETHC2A182KJ |
| 2200 | 22 x 45 | 2.60 | 2.99 | 0.113 | 0.073 | EETHC2A222HA | EETHC2A222HJ |
| | 25 x 40 | 2.60 | 2.99 | 0.113 | 0.073 | EETHC2A222JA | EETHC2A222JJ |
| | 30 x 30 | 2.60 | 2.99 | 0.113 | 0.073 | EETHC2A222KA | EETHC2A222KJ |
| | 35 x 25 | 2.60 | 2.99 | 0.113 | 0.073 | EETHC2A222LA | EETHC2A222LJ |
| 2700 | 25 x 45 | 2.90 | 3.34 | 0.092 | 0.060 | EETHC2A272JA | EETHC2A272JJ |
| | 30 x 35 | 2.90 | 3.34 | 0.092 | 0.060 | EETHC2A272KA | EETHC2A272KJ |
| 3300 | 25 x 50 | 3.20 | 3.68 | 0.075 | 0.049 | EETHC2A332JA | EETHC2A332JJ |
| | 30 x 40 | 3.20 | 3.68 | 0.075 | 0.049 | EETHC2A332KA | EETHC2A332KJ |
| | 35 x 30 | 3.20 | 3.68 | 0.075 | 0.049 | EETHC2A332LA | EETHC2A332LJ |
| 3900 | 30 x 45 | 3.60 | 4.14 | 0.064 | 0.043 | EETHC2A392KA | EETHC2A392KJ |
| | 35 x 35 | 3.60 | 4.14 | 0.064 | 0.043 | EETHC2A392LA | EETHC2A392LJ |
| 4700 | 30 x 50 | 3.80 | 4.37 | 0.053 | 0.038 | EETHC2A472KA | EETHC2A472KJ |
| | 35 x 40 | 3.80 | 4.37 | 0.053 | 0.037 | EETHC2A472LA | EETHC2A472LJ |
| 5600 | 35 x 45 | 4.20 | 4.83 | 0.044 | 0.031 | EETHC2A562LA | EETHC2A562LJ |
| 6800 | 35 x 50 | 4.70 | 5.41 | 0.037 | 0.027 | EETHC2A682LA | EETHC2A682LJ |
| 160 VDC Working, 200 VDC Surge | | | | | | | |
| 470 | 22 x 25 | 1.40 | 1.96 | 0.423 | 0.190 | EETHC2C471HA | EETHC2C471HJ |

Design and specifications are subject to change without notice.

Contact the factory or your sales representative for technical specifications before purchase and/or use.

When safety concerns arise, please contact Panasonic immediately for technical consultation.

TS-HC Standard Ratings (continued)

Part numbers shown with 2 pins and 4.0mm length terminals

| Cap. (μ F) | Size (mm) D x L | Max 105°C R.C. (A_{rms}) | | 20°C ESR (Ω , max.) | | Panasonic Part Number (By Sleeve Style) | |
|---------------------------------------------------|--------------------|------------------------------|--------|-----------------------------|-------|-----------------------------------------|------------------------------|
| | | 120Hz | 10kHz~ | 120Hz | 20kHz | PVC sleeve with Top Plate | PET sleeve without Top Plate |
| 160 VDC Working, 200 VDC Surge (continued) | | | | | | | |
| 560 | 22 x 30 | 1.50 | 2.10 | 0.355 | 0.160 | EETHC2C561HA | EETHC2C561HJ |
| 680 | 22 x 30 | 1.70 | 2.38 | 0.293 | 0.132 | EETHC2C681HA | EETHC2C681HJ |
| | 25 x 25 | 1.70 | 2.38 | 0.293 | 0.132 | EETHC2C681JA | EETHC2C681JJ |
| 820 | 22 x 35 | 2.00 | 2.80 | 0.243 | 0.109 | EETHC2C821HA | EETHC2C821HJ |
| | 25 x 30 | 2.00 | 2.80 | 0.243 | 0.109 | EETHC2C821JA | EETHC2C821JJ |
| 1000 | 22 x 40 | 2.20 | 3.08 | 0.199 | 0.090 | EETHC2C102HA | EETHC2C102HJ |
| | 25 x 35 | 2.20 | 3.08 | 0.199 | 0.090 | EETHC2C102JA | EETHC2C102JJ |
| 1000 | 30 x 25 | 2.20 | 3.08 | 0.216 | 0.108 | EETHC2C102KA | EETHC2C102KJ |
| | 1200 | 22 x 45 | 2.30 | 3.22 | 0.166 | 0.075 | EETHC2C122HA |
| 1200 | 25 x 40 | 2.30 | 3.22 | 0.166 | 0.075 | EETHC2C122JA | EETHC2C122JJ |
| | 30 x 30 | 2.30 | 3.22 | 0.166 | 0.075 | EETHC2C122KA | EETHC2C122KJ |
| 1200 | 35 x 25 | 2.30 | 3.22 | 0.180 | 0.090 | EETHC2C122LA | EETHC2C122LJ |
| | 1500 | 25 x 45 | 2.50 | 3.50 | 0.133 | 0.060 | EETHC2C152JA |
| 1500 | 30 x 35 | 2.50 | 3.50 | 0.133 | 0.060 | EETHC2C152KA | EETHC2C152KJ |
| | 35 x 30 | 2.50 | 3.50 | 0.155 | 0.077 | EETHC2C152LA | EETHC2C152LJ |
| 1800 | 25 x 50 | 2.70 | 3.78 | 0.111 | 0.050 | EETHC2C182JA | EETHC2C182JJ |
| | 30 x 40 | 2.70 | 3.78 | 0.111 | 0.050 | EETHC2C182KA | EETHC2C182KJ |
| 1800 | 35 x 30 | 2.70 | 3.78 | 0.120 | 0.060 | EETHC2C182LA | EETHC2C182LJ |
| | 2200 | 30 x 45 | 2.90 | 4.06 | 0.090 | 0.041 | EETHC2C222KA |
| 2200 | 35 x 35 | 2.90 | 4.06 | 0.098 | 0.049 | EETHC2C222LA | EETHC2C222LJ |
| | 2700 | 30 x 50 | 3.10 | 4.34 | 0.080 | 0.040 | EETHC2C272KA |
| 2700 | 35 x 40 | 3.10 | 4.34 | 0.086 | 0.043 | EETHC2C272LA | EETHC2C272LJ |
| | 3300 | 35 x 50 | 3.30 | 4.62 | 0.070 | 0.042 | EETHC2C332LA |
| 200 VDC Working, 250 VDC Surge | | | | | | | |
| 390 | 22 x 25 | 1.31 | 1.83 | 0.510 | 0.230 | EETHC2D391HA | EETHC2D391HJ |
| 470 | 22 x 30 | 1.45 | 2.03 | 0.423 | 0.190 | EETHC2D471HA | EETHC2D471HJ |
| | 25 x 25 | 1.45 | 2.03 | 0.423 | 0.190 | EETHC2D471JF | EETHC2D471JC |
| 560 | 22 x 30 | 1.67 | 2.34 | 0.355 | 0.160 | EETHC2D561HA | EETHC2D561HJ |
| 680 | 22 x 40 | 1.75 | 2.45 | 0.293 | 0.132 | EETHC2D681HA | EETHC2D681HJ |
| | 25 x 30 | 1.75 | 2.45 | 0.293 | 0.132 | EETHC2D681JA | EETHC2D681JJ |
| 820 | 22 x 45 | 2.04 | 2.86 | 0.243 | 0.109 | EETHC2D821HA | EETHC2D821HJ |
| | 25 x 35 | 2.04 | 2.86 | 0.243 | 0.109 | EETHC2D821JA | EETHC2D821JJ |
| 820 | 30 x 25 | 2.04 | 2.86 | 0.243 | 0.109 | EETHC2D821KA | EETHC2D821KJ |
| | 1000 | 22 x 50 | 2.30 | 3.22 | 0.199 | 0.090 | EETHC2D102HA |
| 1000 | 25 x 40 | 2.30 | 2.90 | 0.199 | 0.090 | EETHC2D102JF | EETHC2D102JC |
| | 25 x 45 | 2.30 | 3.22 | 0.199 | 0.090 | EETHC2D102JA | EETHC2D102JJ |
| 1000 | 30 x 30 | 2.30 | 3.22 | 0.199 | 0.090 | EETHC2D102KA | EETHC2D102KJ |
| | 35 x 25 | 2.30 | 3.22 | 0.216 | 0.097 | EETHC2D102LA | EETHC2D102LA |
| 1200 | 25 x 45 | 2.65 | 3.33 | 0.166 | 0.075 | EETHC2D122JF | EETHC2D122JC |
| | 25 x 50 | 2.65 | 3.71 | 0.166 | 0.075 | EETHC2D122JA | EETHC2D122JJ |
| 1200 | 30 x 35 | 2.65 | 3.71 | 0.166 | 0.075 | EETHC2D122KA | EETHC2D122KJ |
| | 35 x 30 | 2.65 | 3.71 | 0.180 | 0.090 | EETHC2D122LA | EETHC2D122LA |
| 1500 | 30 x 40 | 2.80 | 3.92 | 0.133 | 0.060 | EETHC2D152KA | EETHC2D152KJ |
| | 35 x 30 | 2.80 | 3.92 | 0.144 | 0.072 | EETHC2D152LA | EETHC2D152LA |
| 1800 | 30 x 45 | 3.08 | 4.31 | 0.111 | 0.050 | EETHC2D182KA | EETHC2D182KJ |
| | 35 x 40 | 3.08 | 4.31 | 0.129 | 0.064 | EETHC2D182LA | EETHC2D182LA |
| 2200 | 30 x 50 | 3.48 | 4.87 | 0.090 | 0.041 | EETHC2D222KA | EETHC2D222KJ |
| | 35 x 45 | 3.48 | 4.87 | 0.098 | 0.044 | EETHC2D222LA | EETHC2D222LA |
| 250 VDC Working, 300 VDC Surge | | | | | | | |
| 270 | 22 x 25 | 1.10 | 1.54 | 0.614 | 0.276 | EETHC2E271HA | EETHC2E271HJ |
| 330 | 22 x 30 | 1.20 | 1.68 | 0.502 | 0.226 | EETHC2E331HA | EETHC2E331HJ |
| | 25 x 25 | 1.20 | 1.68 | 0.502 | 0.226 | EETHC2E331JA | EETHC2E331JJ |
| 390 | 22 x 30 | 1.20 | 1.68 | 0.425 | 0.191 | EETHC2E391HF | EETHC2E391HC |
| | 22 x 35 | 1.30 | 1.82 | 0.425 | 0.191 | EETHC2E391HA | EETHC2E391HJ |
| 390 | 25 x 25 | 1.30 | 1.82 | 0.425 | 0.191 | EETHC2E391JA | EETHC2E391JJ |
| | 470 | 22 x 35 | 1.20 | 1.68 | 0.353 | 0.159 | EETHC2E471HF |
| 470 | 22 x 40 | 1.40 | 1.96 | 0.353 | 0.159 | EETHC2E471HA | EETHC2E471HJ |
| | 25 x 30 | 1.40 | 1.96 | 0.353 | 0.159 | EETHC2E471JA | EETHC2E471JJ |
| 470 | 30 x 25 | 1.40 | 1.96 | 0.353 | 0.159 | EETHC2E471KA | EETHC2E471KJ |
| | 560 | 22 x 40 | 1.40 | 1.96 | 0.296 | 0.133 | EETHC2E561HF |
| 560 | 22 x 45 | 1.50 | 2.10 | 0.296 | 0.133 | EETHC2E561HA | EETHC2E561HJ |
| | 25 x 35 | 1.50 | 2.10 | 0.296 | 0.133 | EETHC2E561JA | EETHC2E561JJ |
| 560 | 30 x 25 | 1.50 | 2.10 | 0.296 | 0.133 | EETHC2E561KA | EETHC2E561KJ |

Design and specifications are subject to change without notice.

Contact the factory or your sales representative for technical specifications before purchase and/or use.

When safety concerns arise, please contact Panasonic immediately for technical consultation.

TS-HC Standard Ratings (continued)

Part numbers shown with 2 pins and 4.0mm length terminals

| Cap. (μ F) | Size (mm) D x L | Max 105°C R.C. (A_{rms}) | | 20°C ESR (Ω , max.) | | Panasonic Part Number (By Sleeveing Style) | |
|---------------------------------------------------|--------------------|------------------------------|--------|-----------------------------|-------|--------------------------------------------|-----------------------|
| | | 120Hz | 10kHz~ | 120Hz | 20kHz | PVC with Top Plate | PET without Top Plate |
| 250 VDC Working, 300 VDC Surge (continued) | | | | | | | |
| 680 | 22 x 45 | 1.50 | 2.10 | 0.244 | 0.110 | EETHC2E681HF | EETHC2E681HC |
| | 22 x 50 | 1.70 | 2.38 | 0.244 | 0.110 | EETHC2E681HA | EETHC2E681HJ |
| | 25 x 40 | 1.70 | 2.38 | 0.244 | 0.110 | EETHC2E681JA | EETHC2E681JJ |
| | 30 x 30 | 1.70 | 2.38 | 0.244 | 0.110 | EETHC2E681KA | EETHC2E681KJ |
| | 35 x 25 | 1.70 | 2.38 | 0.244 | 0.110 | EETHC2E681LA | EETHC2E681LJ |
| 820 | 25 x 45 | 2.00 | 2.80 | 0.202 | 0.091 | EETHC2E821JA | EETHC2E821JJ |
| | 30 x 35 | 2.00 | 2.80 | 0.202 | 0.091 | EETHC2E821KA | EETHC2E821KJ |
| | 35 x 30 | 2.00 | 2.80 | 0.202 | 0.091 | EETHC2E821LA | EETHC2E821LJ |
| 1000 | 25 x 50 | 2.20 | 3.08 | 0.166 | 0.075 | EETHC2E102JF | EETHC2E102JC |
| | 30 x 40 | 2.20 | 3.08 | 0.166 | 0.075 | EETHC2E102KA | EETHC2E102KJ |
| | 35 x 30 | 2.20 | 3.08 | 0.166 | 0.075 | EETHC2E102LA | EETHC2E102LJ |
| 1200 | 30 x 45 | 2.30 | 3.22 | 0.138 | 0.062 | EETHC2E122KA | EETHC2E122KJ |
| | 35 x 35 | 2.30 | 3.22 | 0.138 | 0.062 | EETHC2E122LA | EETHC2E122LJ |
| 1500 | 35 x 45 | 2.50 | 3.50 | 0.111 | 0.050 | EETHC2E152LA | EETHC2E152LJ |
| 1800 | 35 x 45 | 2.50 | 3.50 | 0.092 | 0.041 | EETHC2E182LF | EETHC2E182LC |
| | 35 x 50 | 2.70 | 3.78 | 0.092 | 0.041 | EETHC2E182LA | EETHC2E182LJ |
| 350 VDC Working, 400 VDC Surge | | | | | | | |
| 120 | 22 x 25 | 0.75 | 1.05 | 1.382 | 0.622 | EETHC2V121HA | EETHC2V121HJ |
| 150 | 22 x 30 | 0.82 | 1.15 | 1.105 | 0.497 | EETHC2V151HA | EETHC2V151HJ |
| 180 | 22 x 30 | 0.90 | 1.26 | 0.921 | 0.414 | EETHC2V181HA | EETHC2V181HJ |
| | 25 x 25 | 0.90 | 1.26 | 0.921 | 0.414 | EETHC2V181JA | EETHC2V181JJ |
| 220 | 22 x 35 | 1.00 | 1.40 | 0.754 | 0.339 | EETHC2V221HA | EETHC2V221HJ |
| | 25 x 30 | 1.00 | 1.40 | 0.754 | 0.339 | EETHC2V221JA | EETHC2V221JJ |
| 270 | 22 x 40 | 1.10 | 1.54 | 0.614 | 0.276 | EETHC2V271HF | EETHC2V271HC |
| | 25 x 35 | 1.10 | 1.54 | 0.614 | 0.276 | EETHC2V271JA | EETHC2V271JJ |
| | 30 x 25 | 1.10 | 1.54 | 0.614 | 0.276 | EETHC2V271KA | EETHC2V271KJ |
| 330 | 22 x 45 | 1.20 | 1.68 | 0.502 | 0.226 | EETHC2V331HF | EETHC2V331HC |
| | 25 x 40 | 1.20 | 1.68 | 0.502 | 0.226 | EETHC2V331JA | EETHC2V331JJ |
| | 30 x 30 | 1.20 | 1.68 | 0.502 | 0.226 | EETHC2V331KA | EETHC2V331KJ |
| 390 | 25 x 45 | 1.30 | 1.82 | 0.425 | 0.191 | EETHC2V391JA | EETHC2V391JJ |
| | 30 x 30 | 1.30 | 1.82 | 0.425 | 0.191 | EETHC2V391KF | EETHC2V391KC |
| | 30 x 35 | 1.30 | 1.82 | 0.425 | 0.191 | EETHC2V391KA | EETHC2V391KJ |
| 470 | 25 x 50 | 1.40 | 1.96 | 0.353 | 0.159 | EETHC2V471JA | EETHC2V471JJ |
| | 30 x 35 | 1.40 | 1.96 | 0.353 | 0.159 | EETHC2V471KF | EETHC2V471KC |
| | 35 x 30 | 1.40 | 1.96 | 0.353 | 0.159 | EETHC2V471LA | EETHC2V471LJ |
| 560 | 30 x 40 | 1.50 | 2.10 | 0.296 | 0.133 | EETHC2V561KF | EETHC2V561KC |
| | 30 x 45 | 1.50 | 2.10 | 0.296 | 0.133 | EETHC2V561KA | EETHC2V561KJ |
| | 35 x 35 | 1.50 | 2.10 | 0.296 | 0.133 | EETHC2V561LA | EETHC2V561LJ |
| 680 | 30 x 45 | 1.70 | 2.38 | 0.244 | 0.110 | EETHC2V681KF | EETHC2V681KC |
| | 30 x 50 | 1.70 | 2.38 | 0.244 | 0.110 | EETHC2V681KA | EETHC2V681KJ |
| | 35 x 40 | 1.70 | 2.38 | 0.244 | 0.110 | EETHC2V681LA | EETHC2V681LJ |
| 820 | 35 x 45 | 1.90 | 2.66 | 0.202 | 0.091 | EETHC2V821LA | EETHC2V821LJ |
| 1000 | 35 x 50 | 1.90 | 2.66 | 0.202 | 0.091 | EETHC2V102LF | EETHC2V102LC |
| 400 VDC Working, 450 VDC Surge | | | | | | | |
| 100 | 22 x 25 | 0.70 | 0.98 | 1.824 | 0.821 | EETHC2G101HA | EETHC2G101HJ |
| 120 | 22 x 30 | 0.75 | 1.05 | 1.520 | 0.684 | EETHC2G121HA | EETHC2G121HJ |
| 150 | 22 x 30 | 0.88 | 1.23 | 1.216 | 0.547 | EETHC2G151HA | EETHC2G151HJ |
| | 25 x 25 | 0.88 | 1.23 | 1.216 | 0.547 | EETHC2G151JF | EETHC2G151JC |
| 180 | 22 x 35 | 0.95 | 1.33 | 1.013 | 0.456 | EETHC2G181HA | EETHC2G181HJ |
| | 25 x 30 | 0.95 | 1.33 | 1.013 | 0.456 | EETHC2G181JA | EETHC2G181JJ |
| 220 | 22 x 40 | 1.00 | 1.40 | 0.829 | 0.373 | EETHC2G221HF | EETHC2G221HC |
| | 22 x 45 | 1.10 | 1.54 | 0.829 | 0.373 | EETHC2G221HA | EETHC2G221HJ |
| | 25 x 35 | 1.10 | 1.54 | 0.829 | 0.373 | EETHC2G221JA | EETHC2G221JJ |
| | 30 x 25 | 1.10 | 1.54 | 0.829 | 0.373 | EETHC2G221KA | EETHC2G221KJ |
| 270 | 22 x 45 | 1.10 | 1.54 | 0.675 | 0.304 | EETHC2G271HF | EETHC2G271HC |
| | 22 x 50 | 1.22 | 1.71 | 0.675 | 0.304 | EETHC2G271HA | EETHC2G271HJ |
| | 25 x 40 | 1.22 | 1.71 | 0.675 | 0.304 | EETHC2G271JA | EETHC2G271JJ |
| | 30 x 30 | 1.22 | 1.71 | 0.675 | 0.304 | EETHC2G271KA | EETHC2G271KJ |
| | 35 x 25 | 1.22 | 1.71 | 0.675 | 0.304 | EETHC2G271LA | EETHC2G271LJ |
| 330 | 25 x 45 | 1.44 | 2.02 | 0.553 | 0.249 | EETHC2G331JA | EETHC2G331JJ |
| | 30 x 30 | 1.44 | 2.02 | 0.553 | 0.249 | EETHC2G331KF | EETHC2G331KC |
| | 30 x 35 | 1.44 | 2.02 | 0.553 | 0.249 | EETHC2G331KA | EETHC2G331KJ |
| | 35 x 30 | 1.44 | 2.02 | 0.553 | 0.249 | EETHC2G331LA | EETHC2G331LJ |
| 390 | 25 x 50 | 1.55 | 2.17 | 0.468 | 0.210 | EETHC2G391JA | EETHC2G391JJ |
| | 30 x 35 | 1.40 | 1.96 | 0.468 | 0.210 | EETHC2G391KF | EETHC2G391KC |

Design and specifications are subject to change without notice.

Contact the factory or your sales representative for technical specifications before purchase and/or use.

When safety concerns arise, please contact Panasonic immediately for technical consultation.

TS-HC Standard Ratings (continued)

Part numbers shown with 2 pins and 4.0mm length terminals

| Cap. (μ F) | Size (mm) D x L | Max 85°C R.C. (A_{rms}) | | 20°C ESR (Ω , max.) | | Panasonic Part Number (By Sleeveing Style) | |
|---------------------------------------------------|--------------------|-----------------------------|--------|-----------------------------|-------|--------------------------------------------|-----------------------|
| | | 120Hz | 10kHz~ | 120Hz | 20kHz | PVC with Top Plate | PET without Top Plate |
| 400 VDC Working, 450 VDC Surge (continued) | | | | | | | |
| 390 | 30 x 40 | 1.55 | 2.17 | 0.468 | 0.210 | EETHC2G391KA | EETHC2G391KJ |
| | 35 x 30 | 1.55 | 2.17 | 0.468 | 0.210 | EETHC2G391LA | EETHC2G391LJ |
| 470 | 30 x 45 | 1.68 | 2.35 | 0.388 | 0.175 | EETHC2G471KA | EETHC2G471KJ |
| | 35 x 35 | 1.68 | 2.35 | 0.388 | 0.175 | EETHC2G471LA | EETHC2G471LJ |
| 560 | 30 x 45 | 1.90 | 2.66 | 0.326 | 0.147 | EETHC2G561KF | EETHC2G561KC |
| | 30 x 50 | 1.90 | 2.66 | 0.326 | 0.147 | EETHC2G561KA | EETHC2G561KJ |
| | 35 x 40 | 1.90 | 2.66 | 0.326 | 0.147 | EETHC2G561LA | EETHC2G561LJ |
| 680 | 35 x 45 | 2.12 | 2.97 | 0.268 | 0.121 | EETHC2G681LA | EETHC2G681LJ |
| 820 | 35 x 50 | 2.30 | 3.22 | 0.202 | 0.091 | EETHC2G821LA | EETHC2G821LJ |
| 420 VDC Working, 470 VDC Surge | | | | | | | |
| 120 | 22 x 30 | 0.74 | 1.04 | 1.520 | 0.684 | EETHC2S121HA | EETHC2S121HJ |
| | 25 x 25 | 0.74 | 1.04 | 1.520 | 0.684 | EETHC2S121JA | EETHC2S121JJ |
| 150 | 22 x 35 | 0.84 | 1.18 | 1.216 | 0.547 | EETHC2S151HA | EETHC2S151HJ |
| 180 | 22 x 40 | 0.91 | 1.27 | 1.103 | 0.456 | EETHC2S181HA | EETHC2S181HJ |
| | 25 x 30 | 0.91 | 1.27 | 1.103 | 0.456 | EETHC2S181JA | EETHC2S181JJ |
| 220 | 22 x 45 | 1.05 | 1.47 | 0.829 | 0.373 | EETHC2S221HA | EETHC2S221HJ |
| | 25 x 35 | 1.05 | 1.47 | 0.829 | 0.373 | EETHC2S221JA | EETHC2S221JJ |
| | 30 x 25 | 1.05 | 1.47 | 0.829 | 0.373 | EETHC2S221KA | EETHC2S221KJ |
| 270 | 22 x 50 | 1.20 | 1.68 | 0.675 | 0.304 | EETHC2S271HA | EETHC2S271HJ |
| | 25 x 40 | 1.20 | 1.68 | 0.675 | 0.304 | EETHC2S271JA | EETHC2S271JJ |
| | 30 x 30 | 1.20 | 1.68 | 0.675 | 0.304 | EETHC2S271KA | EETHC2S271KJ |
| | 35 x 25 | 1.20 | 1.68 | 0.675 | 0.304 | EETHC2S271LA | EETHC2S271LJ |
| 330 | 25 x 50 | 1.42 | 1.99 | 0.553 | 0.249 | EETHC2S331JA | EETHC2S331JJ |
| 330 | 30 x 35 | 1.42 | 1.99 | 0.553 | 0.249 | EETHC2S331KA | EETHC2S331KJ |
| | 35 x 35 | 1.42 | 1.99 | 0.553 | 0.249 | EETHC2S331LA | EETHC2S331LJ |
| 390 | 30 x 40 | 1.55 | 2.17 | 0.468 | 0.210 | EETHC2S391KA | EETHC2S391KJ |
| | 35 x 35 | 1.55 | 2.17 | 0.468 | 0.210 | EETHC2S391LA | EETHC2S391LJ |
| 470 | 30 x 45 | 1.71 | 2.39 | 0.388 | 0.175 | EETHC2S471KA | EETHC2S471KJ |
| | 35 x 35 | 1.71 | 2.39 | 0.388 | 0.175 | EETHC2S471LA | EETHC2S471LJ |
| 560 | 30 x 50 | 1.90 | 2.66 | 0.326 | 0.147 | EETHC2S561KA | EETHC2S561KJ |
| | 35 x 45 | 1.90 | 2.66 | 0.326 | 0.147 | EETHC2S561LA | EETHC2S561LJ |
| 680 | 35 x 50 | 2.10 | 2.94 | 0.268 | 0.121 | EETHC2S681LA | EETHC2S681LJ |
| 450 VDC Working, 500 VDC Surge | | | | | | | |
| 100 | 22 x 30 | 0.64 | 0.90 | 1.824 | 0.821 | EETHC2W101HA | EETHC2W101HJ |
| | 25 x 25 | 0.64 | 0.90 | 1.824 | 0.821 | EETHC2W101JA | EETHC2W101JJ |
| 120 | 22 x 35 | 0.72 | 1.01 | 1.520 | 0.684 | EETHC2W121HA | EETHC2W121HJ |
| | 25 x 30 | 0.72 | 1.01 | 1.520 | 0.684 | EETHC2W121JA | EETHC2W121JJ |
| 150 | 22 x 40 | 0.79 | 1.11 | 1.216 | 0.547 | EETHC2W151HA | EETHC2W151HJ |
| | 25 x 30 | 0.79 | 1.11 | 1.216 | 0.547 | EETHC2W151JA | EETHC2W151JJ |
| | 30 x 25 | 0.79 | 1.11 | 1.216 | 0.547 | EETHC2W151KA | EETHC2W151KJ |
| 180 | 22 x 45 | 0.87 | 1.22 | 1.013 | 0.456 | EETHC2W181HA | EETHC2W181HJ |
| | 25 x 35 | 0.79 | 1.11 | 1.013 | 0.456 | EETHC2W181JF | EETHC2W181JC |
| | 25 x 40 | 0.87 | 1.22 | 1.013 | 0.456 | EETHC2W181JA | EETHC2W181JJ |
| | 30 x 30 | 0.87 | 1.22 | 1.013 | 0.456 | EETHC2W181KA | EETHC2W181KJ |
| 220 | 22 x 50 | 0.90 | 1.26 | 0.829 | 0.373 | EETHC2W221HA | EETHC2W221HJ |
| | 25 x 45 | 1.00 | 1.40 | 0.829 | 0.373 | EETHC2W221JA | EETHC2W221JJ |
| | 30 x 30 | 1.00 | 1.40 | 0.829 | 0.373 | EETHC2W221KA | EETHC2W221KJ |
| | 35 x 25 | 1.00 | 1.40 | 0.829 | 0.373 | EETHC2W221LA | EETHC2W221LJ |
| 270 | 25 x 50 | 1.19 | 1.67 | 0.675 | 0.304 | EETHC2W271JA | EETHC2W271JJ |
| | 30 x 35 | 1.07 | 1.50 | 0.675 | 0.304 | EETHC2W271KF | EETHC2W271KC |
| | 30 x 40 | 1.19 | 1.67 | 0.675 | 0.304 | EETHC2W271KA | EETHC2W271KJ |
| | 35 x 30 | 1.19 | 1.67 | 0.675 | 0.304 | EETHC2W271LA | EETHC2W271LJ |
| 330 | 30 x 40 | 1.24 | 1.74 | 0.553 | 0.249 | EETHC2W331KF | EETHC2W331KC |
| | 30 x 45 | 1.38 | 1.93 | 0.553 | 0.249 | EETHC2W331KA | EETHC2W331KJ |
| | 35 x 35 | 1.38 | 1.93 | 0.553 | 0.249 | EETHC2W331LA | EETHC2W331LJ |
| 390 | 30 x 45 | 1.39 | 1.95 | 0.468 | 0.210 | EETHC2W391KF | EETHC2W391KC |
| | 30 x 50 | 1.55 | 2.17 | 0.468 | 0.210 | EETHC2W391KA | EETHC2W391KJ |
| | 35 x 40 | 1.55 | 2.17 | 0.468 | 0.210 | EETHC2W391LA | EETHC2W391LJ |
| 470 | 35 x 45 | 1.74 | 2.44 | 0.388 | 0.175 | EETHC2W471LA | EETHC2W471LJ |
| 560 | 35 x 50 | 1.90 | 2.66 | 0.326 | 0.147 | EETHC2W561LA | EETHC2W561LJ |

Design and specifications are subject to change without notice.

Contact the factory or your sales representative for technical specifications before purchase and/or use.

When safety concerns arise, please contact Panasonic immediately for technical consultation.