

# STARPOWER

SEMICONDUCTOR

**IGBT**

## GD800HFL170C3S

**1700V/800A 2 in one-package**

### General Description

STARPOWER IGBT Power Module provides ultra low conduction loss as well as short circuit ruggedness. They are designed for the applications such as high power converters.

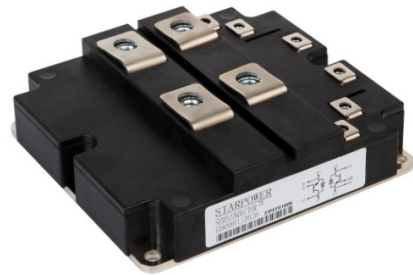

### Features

- Low  $V_{CE(sat)}$  SPT+ IGBT technology
- 10 $\mu$ s short circuit capability
- $V_{CE(sat)}$  with positive temperature coefficient
- Maximum junction temperature 175°C
- Low inductance case
- Fast & soft reverse recovery anti-parallel FWD
- Isolated copper baseplate using DBC technology

### Typical Applications

- High Power Converters
- Motor Drivers
- Wind Turbines

### Equivalent Circuit Schematic

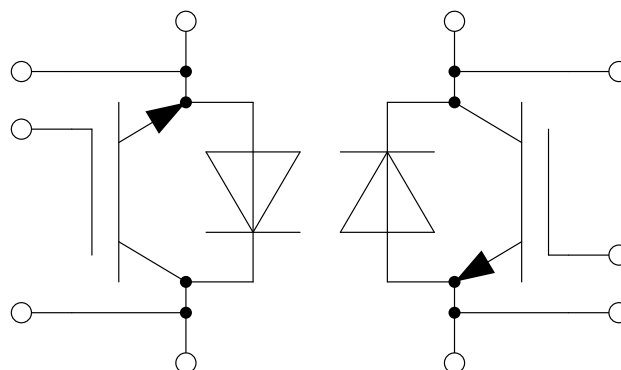

**Absolute Maximum Ratings**  $T_C=25^{\circ}\text{C}$  unless otherwise noted**IGBT**

Symbol	Description	Value	Unit
$V_{CES}$	Collector-Emitter Voltage	1700	V
$V_{GES}$	Gate-Emitter Voltage	$\pm 20$	V
$I_C$	Collector Current @ $T_C=25^{\circ}\text{C}$	1050	A
	@ $T_C=80^{\circ}\text{C}$	800	
$I_{CM}$	Pulsed Collector Current $t_p=1\text{ms}$	1600	A
$P_D$	Maximum Power Dissipation @ $T_j=175^{\circ}\text{C}$	4.85	kW

**Diode**

Symbol	Description	Value	Unit
$V_{RRM}$	Repetitive Peak Reverse Voltage	1700	V
$I_F$	Diode Continuous Forward Current	800	A
$I_{FM}$	Diode Maximum Forward Current $t_p=1\text{ms}$	1600	A

**Module**

Symbol	Description	Value	Unit
$T_{jmax}$	Maximum Junction Temperature	175	$^{\circ}\text{C}$
$T_{jop}$	Operating Junction Temperature	-40 to +150	$^{\circ}\text{C}$
$T_{STG}$	Storage Temperature Range	-40 to +125	$^{\circ}\text{C}$
$V_{ISO}$	Isolation Voltage RMS, $f=50\text{Hz}$ , $t=1\text{min}$	4000	V

**IGBT Characteristics**  $T_c=25^\circ\text{C}$  unless otherwise noted

Symbol	Parameter	Test Conditions	Min.	Typ.	Max.	Unit	
$V_{CE(sat)}$	Collector to Emitter Saturation Voltage	$I_C=800\text{A}, V_{GE}=15\text{V}, T_j=25^\circ\text{C}$		2.50	2.95	V	
		$I_C=800\text{A}, V_{GE}=15\text{V}, T_j=125^\circ\text{C}$		3.00			
		$I_C=800\text{A}, V_{GE}=15\text{V}, T_j=150^\circ\text{C}$		3.10			
$V_{GE(th)}$	Gate-Emitter Threshold Voltage	$I_C=32.0\text{mA}, V_{CE}=V_{GE}, T_j=25^\circ\text{C}$	5.4		7.4	V	
$I_{CES}$	Collector Cut-Off Current	$V_{CE}=V_{CES}, V_{GE}=0\text{V}, T_j=25^\circ\text{C}$			5.0	mA	
$I_{GES}$	Gate-Emitter Leakage Current	$V_{GE}=V_{GES}, V_{CE}=0\text{V}, T_j=25^\circ\text{C}$			400	nA	
$C_{ies}$	Input Capacitance	$V_{CE}=25\text{V}, f=1\text{MHz}, V_{GE}=0\text{V}$		54.0		nF	
$C_{res}$	Reverse Transfer Capacitance				1.84		nF
$Q_G$	Gate Charge	$V_{GE}=-15\dots+15\text{V}$		6.2		$\mu\text{C}$	
$t_{d(on)}$	Turn-On Delay Time	$V_{CC}=900\text{V}, I_C=800\text{A}, R_G=1.5\Omega, V_{GE}=\pm 15\text{V}, T_j=25^\circ\text{C}$		235		ns	
$t_r$	Rise Time				110		ns
$t_{d(off)}$	Turn-Off Delay Time				390		ns
$t_f$	Fall Time				145		ns
$E_{on}$	Turn-On Switching Loss				216		mJ
$E_{off}$	Turn-Off Switching Loss				152		mJ
$t_{d(on)}$	Turn-On Delay Time	$V_{CC}=900\text{V}, I_C=800\text{A}, R_G=1.5\Omega, V_{GE}=\pm 15\text{V}, T_j=125^\circ\text{C}$		250		ns	
$t_r$	Rise Time				120		ns
$t_{d(off)}$	Turn-Off Delay Time				475		ns
$t_f$	Fall Time				155		ns
$E_{on}$	Turn-On Switching Loss				280		mJ
$E_{off}$	Turn-Off Switching Loss				232		mJ
$t_{d(on)}$	Turn-On Delay Time	$V_{CC}=900\text{V}, I_C=800\text{A}, R_G=1.5\Omega, V_{GE}=\pm 15\text{V}, T_j=150^\circ\text{C}$		254		ns	
$t_r$	Rise Time				125		ns
$t_{d(off)}$	Turn-Off Delay Time				500		ns
$t_f$	Fall Time				160		ns
$E_{on}$	Turn-On Switching Loss				312		mJ
$E_{off}$	Turn-Off Switching Loss				256		mJ
$I_{SC}$	SC Data	$t_p \leq 10\mu\text{s}, V_{GE}=15\text{V}, T_j=150^\circ\text{C}, V_{CC}=1000\text{V}, V_{CEM} \leq 1700\text{V}$		2480		A	

**Diode Characteristics**  $T_c=25^\circ\text{C}$  unless otherwise noted

Symbol	Parameter	Test Conditions	Min.	Typ.	Max.	Unit
$V_F$	Diode Forward Voltage	$I_F=800\text{A}, V_{GE}=0\text{V}, T_j=25^\circ\text{C}$		1.80	2.25	V
		$I_F=800\text{A}, V_{GE}=0\text{V}, T_j=125^\circ\text{C}$		1.95		
		$I_F=800\text{A}, V_{GE}=0\text{V}, T_j=150^\circ\text{C}$		1.90		
$Q_r$	Recovered Charge			232		$\mu\text{C}$
$I_{RM}$	Peak Reverse Recovery Current	$V_{CC}=900\text{V}, I_F=800\text{A},$ $-di/dt=8400\text{A}/\mu\text{s}, V_{GE}=\pm 15\text{V},$ $T_j=25^\circ\text{C}$		720		A
$E_{rec}$	Reverse Recovery Energy			134		mJ
$Q_r$	Recovered Charge			360		$\mu\text{C}$
$I_{RM}$	Peak Reverse Recovery Current	$V_{CC}=900\text{V}, I_F=800\text{A},$ $-di/dt=8400\text{A}/\mu\text{s}, V_{GE}=\pm 15\text{V},$ $T_j=125^\circ\text{C}$		840		A
$E_{rec}$	Reverse Recovery Energy			222		mJ
$Q_r$	Recovered Charge			424		$\mu\text{C}$
$I_{RM}$	Peak Reverse Recovery Current	$V_{CC}=900\text{V}, I_F=800\text{A},$ $-di/dt=8400\text{A}/\mu\text{s}, V_{GE}=\pm 15\text{V},$ $T_j=150^\circ\text{C}$		880		A
$E_{rec}$	Reverse Recovery Energy			259		mJ

**Module Characteristics**  $T_c=25^\circ\text{C}$  unless otherwise noted

Symbol	Parameter	Min.	Typ.	Max.	Unit
$L_{CE}$	Stray Inductance		20		nH
$R_{CC'+EE'}$	Module Lead Resistance, Terminal to Chip		0.37		m $\Omega$
$R_{\theta JC}$	Junction-to-Case (per IGBT)			30.9	K/kW
	Junction-to-Case (per Diode)			49.0	
$R_{\theta CS}$	Case-to-Sink (per IGBT)		19.6		K/kW
	Case-to-Sink (per Diode)		31.0		
$R_{\theta CS}$	Case-to-Sink		6.0		K/kW
M	Terminal Connection Torque, Screw M4	1.8		2.1	N.m
	Terminal Connection Torque, Screw M8	8.0		10	
	Mounting Torque, Screw M6	4.25		5.75	
G	Weight of Module		1500		g

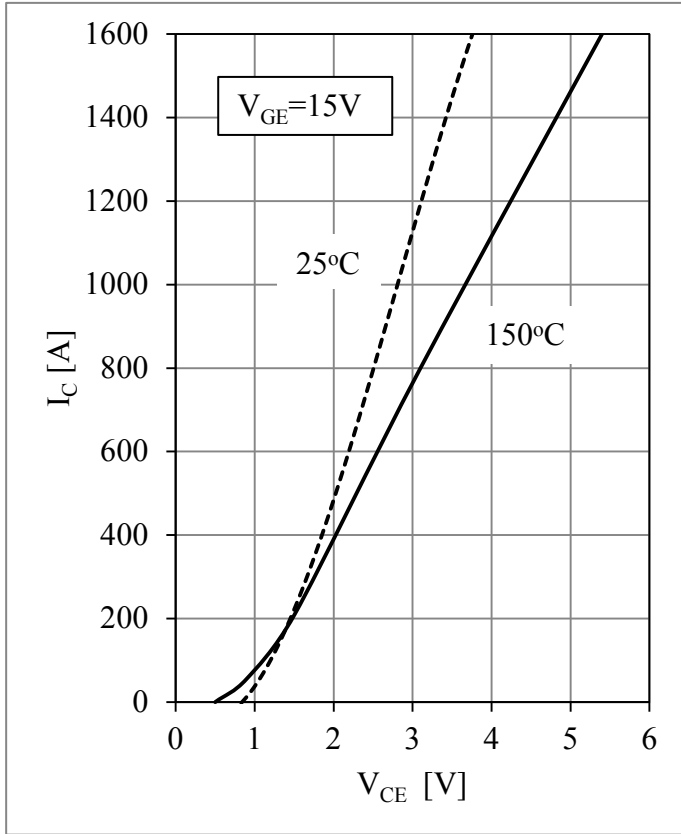

Fig 1. IGBT Output Characteristics

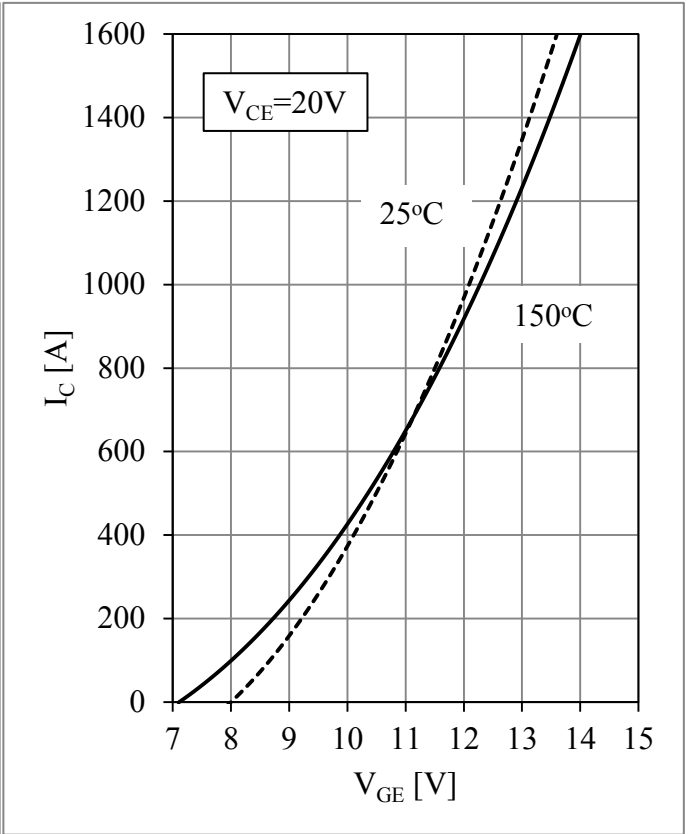

Fig 2. IGBT Transfer Characteristics

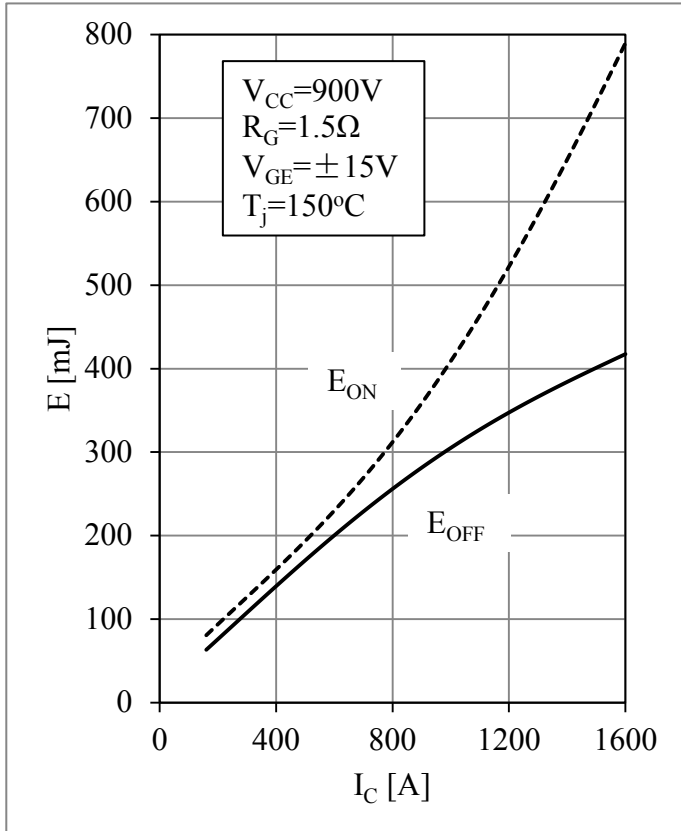

Fig 3. IGBT Switching Loss vs.  $I_C$

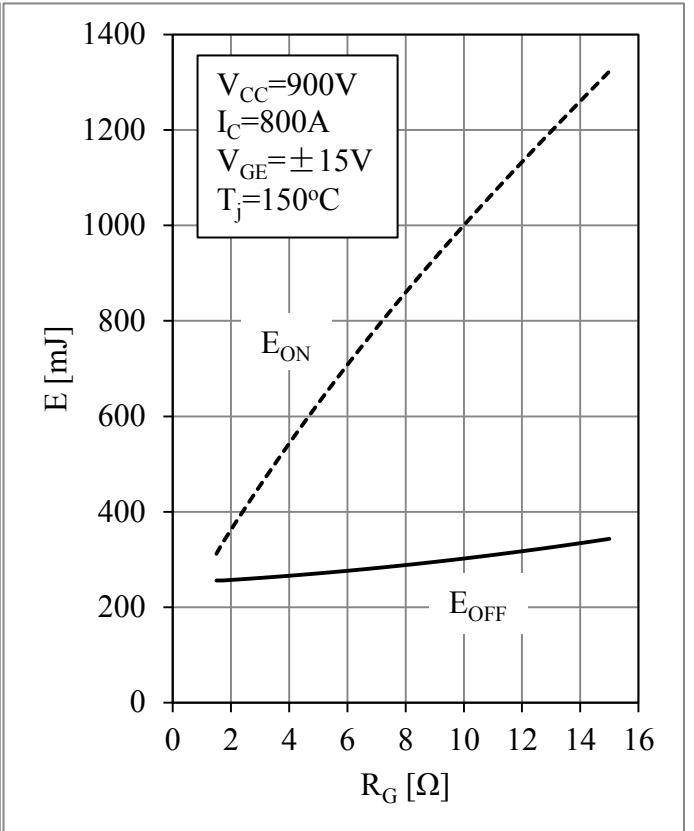

Fig 4. IGBT Switching Loss vs.  $R_G$

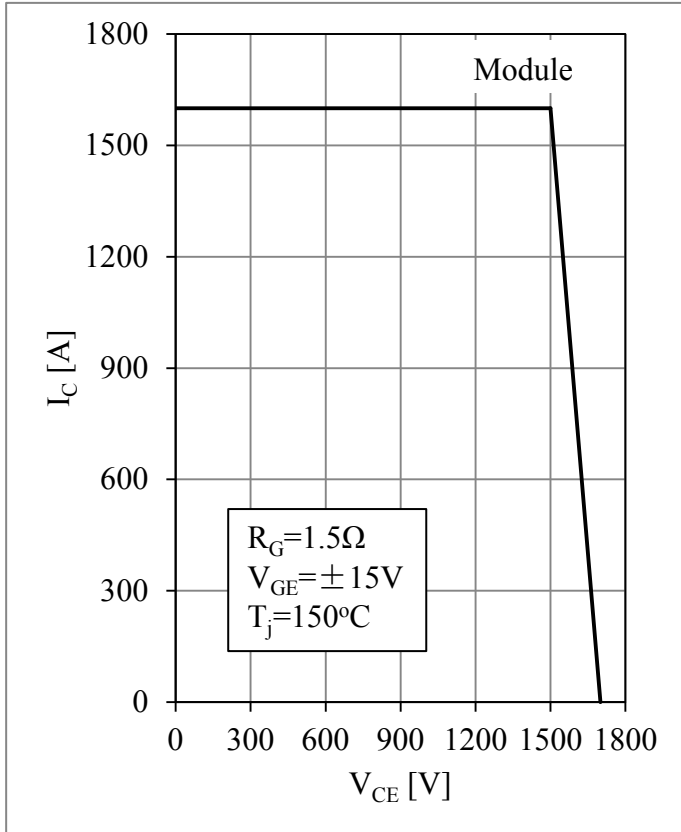

Fig 5. RBSOA

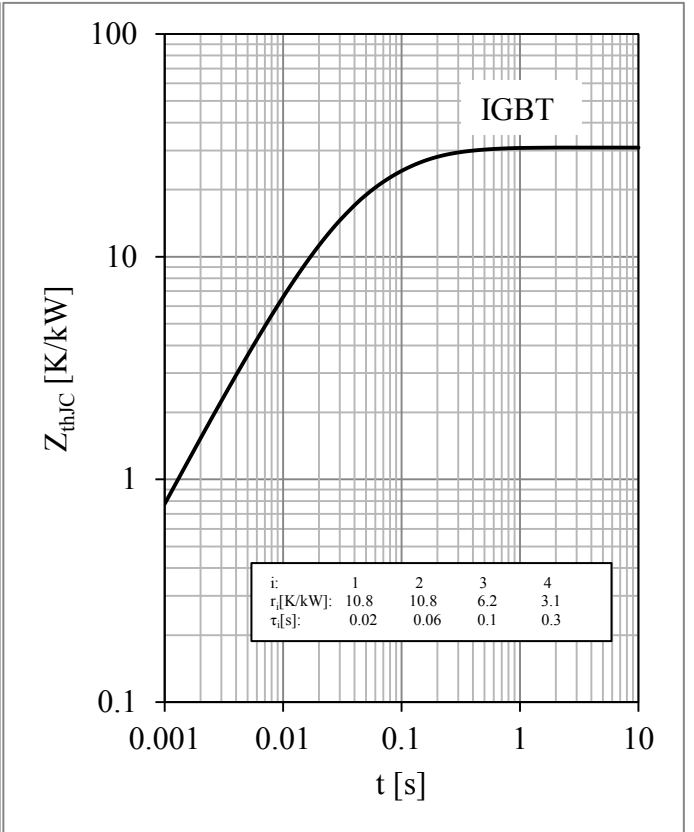

Fig 6. IGBT Transient Thermal Impedance

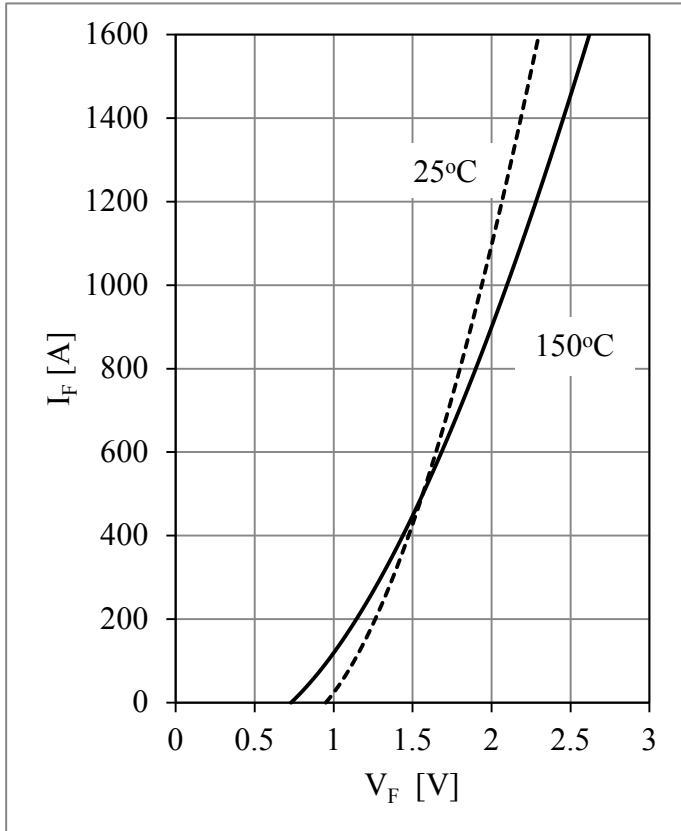

Fig 7. Diode Forward Characteristics

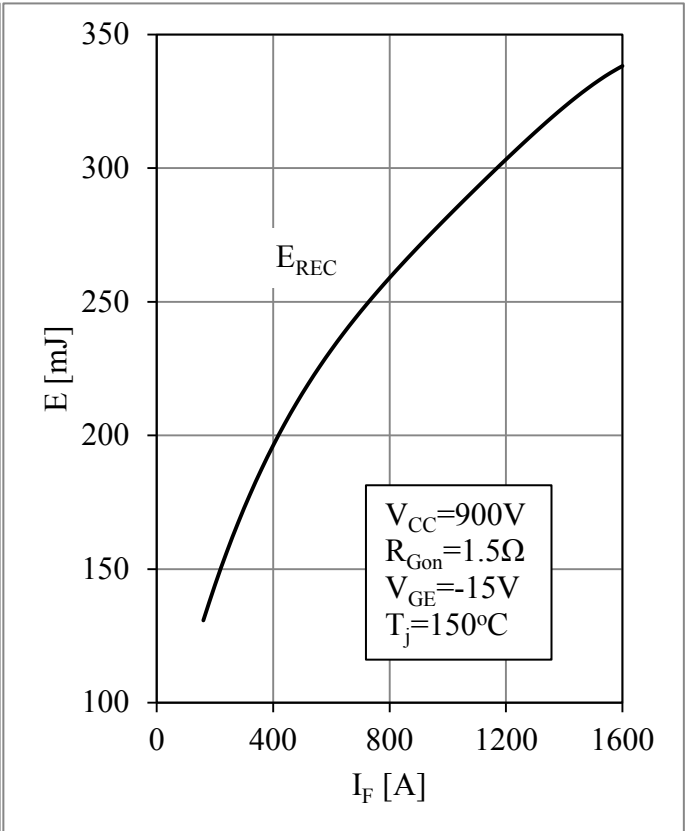

Fig 8. Diode Switching Loss vs.  $I_F$

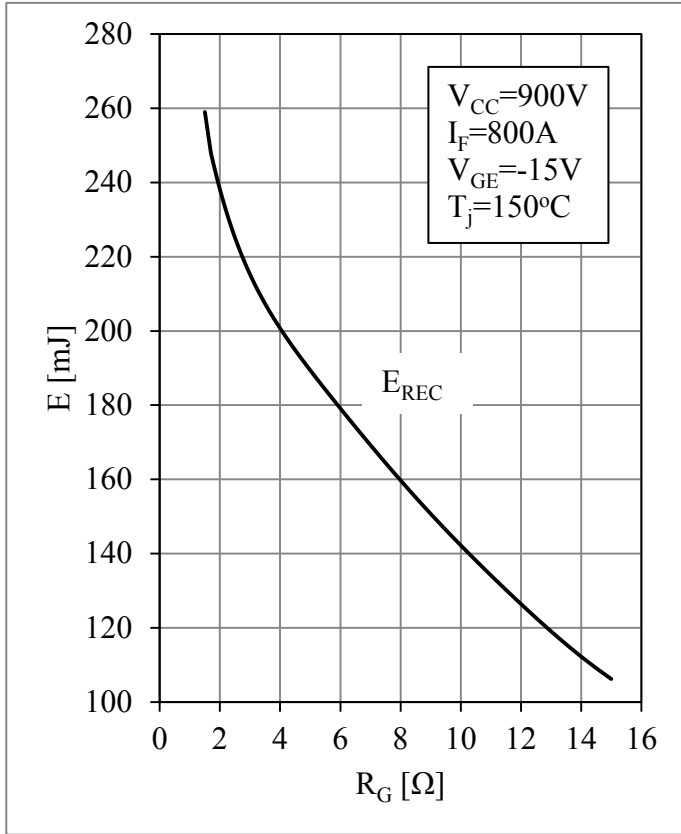

Fig 9. Diode Switching Loss vs.  $R_G$

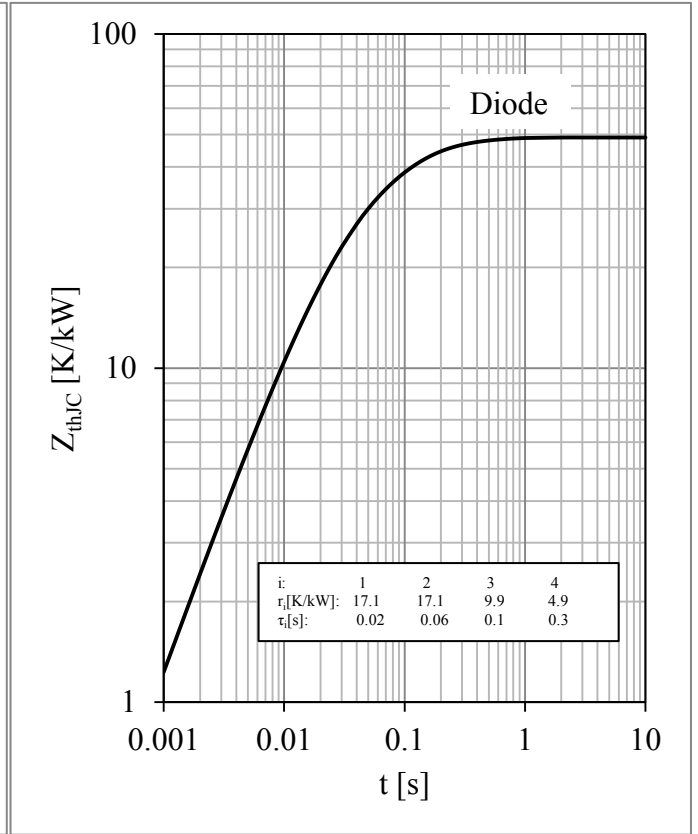
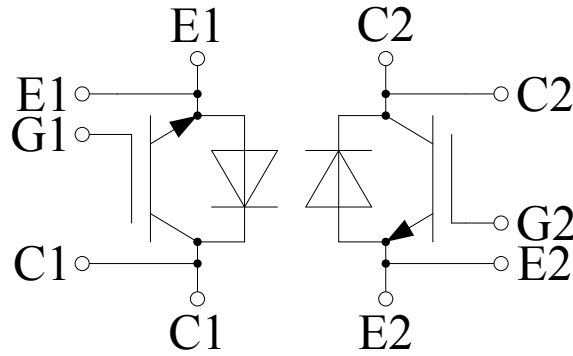

Fig 10. Diode Transient Thermal Impedance

**Circuit Schematic**



**Package Dimensions**

Dimensions in Millimeters

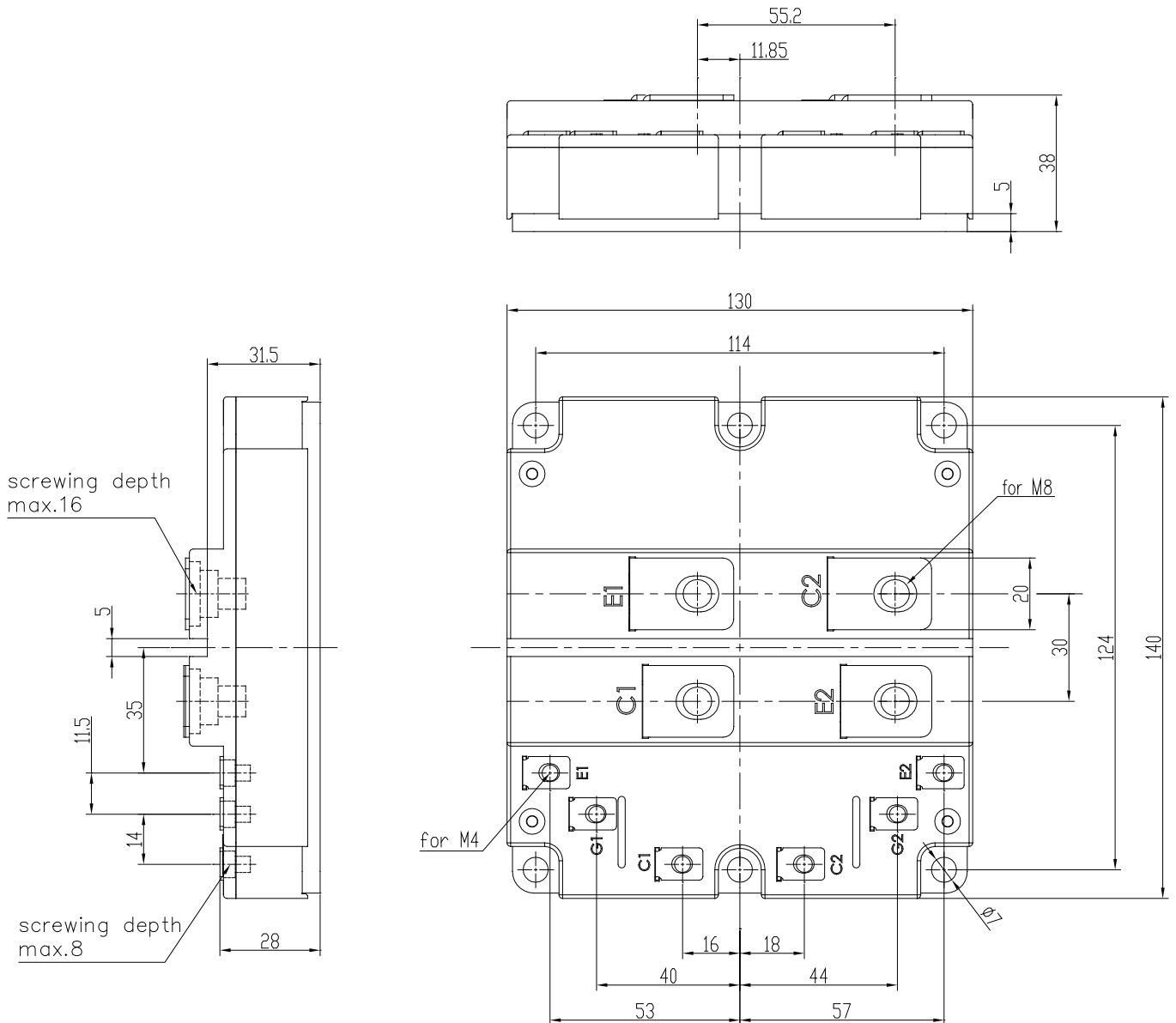



## Terms and Conditions of Usage

The data contained in this product datasheet is exclusively intended for technically trained staff. you and your technical departments will have to evaluate the suitability of the product for the intended application and the completeness of the product data with respect to such application.

This product data sheet is describing the characteristics of this product for which a warranty is granted. Any such warranty is granted exclusively pursuant the terms and conditions of the supply agreement. There will be no guarantee of any kind for the product and its characteristics.

Should you require product information in excess of the data given in this product data sheet or which concerns the specific application of our product, please contact the sales office, which is responsible for you (see [www.powersemi.cc](http://www.powersemi.cc)), For those that are specifically interested we may provide application notes.

Due to technical requirements our product may contain dangerous substances. For information on the types in question please contact the sales office, which is responsible for you.

Should you intend to use the Product in aviation applications, in health or live endangering or life support applications, please notify.

If and to the extent necessary, please forward equivalent notices to your customers.  
Changes of this product data sheet are reserved.