

Mechanical:

REV.	ECN NO.	DESCRIPTION	DATE	APPD
A	REL		2010/07/15	

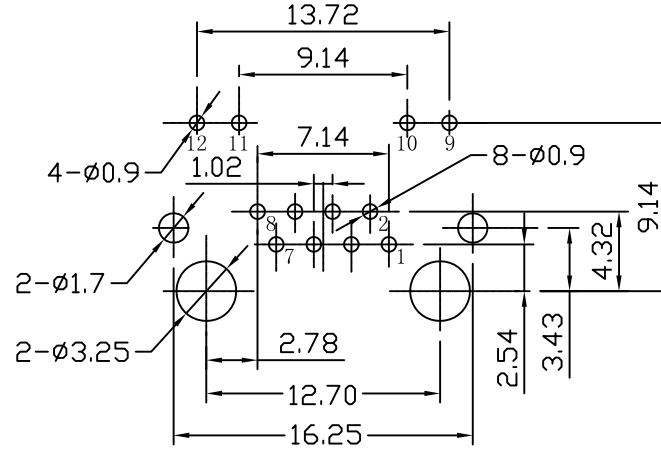

PC Board Layout (TOP VIEW)

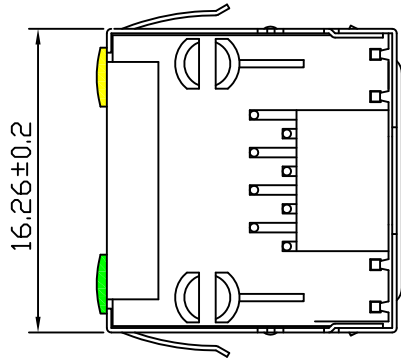
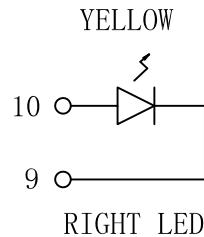
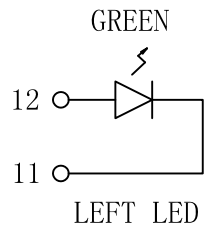
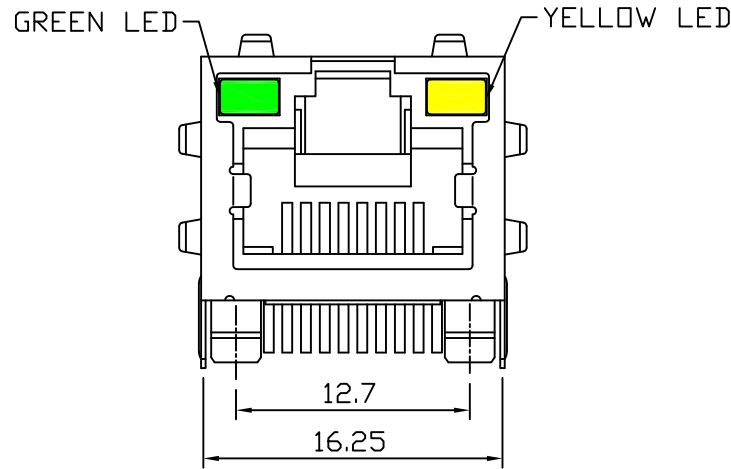
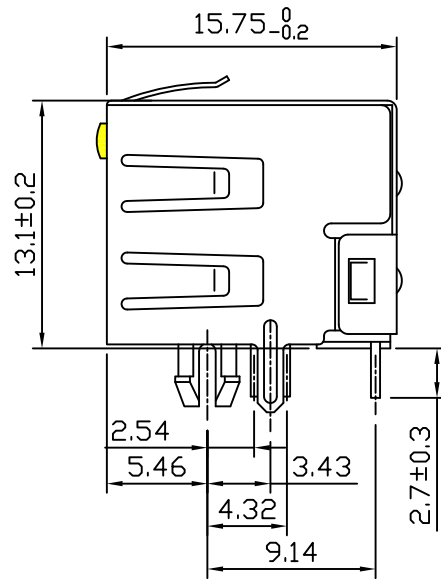

NOTES:

- MACHANICAL:
- HOUSING MATERIAL : GLASS FILLED POLYESTER OR HIGH TEMP. UL94V-0.
 - CONTACT MATERIAL : PHOSPHOR BRONZE $t=0.35\text{mm}$.
 - PLATING : CONTACT AREA-SELECTIVE GOLD PLATING. TAILS-PLATED TIN OVER NICKEL.
 - OPERATING LIFE : 750 CYCLES MIN
 - PCB RETENTION PRE-SOLDER : 1 LB MIN
 - PCB RETENTION POST-SOLDER : 10 LBS MIM
 - LED SIZE : 3.2*2.0*4.0*P=2.29mm

ELECTRICAL:

- VOLTAGE RATING : 125VAC RMS.
- CURRENT RATING : 1.5AMP.
- CONTACT RESISTANCE : 50 MILLIOHMS MAX.
- INSULATION RESISTANCE : 1000MEGOHMS MIN @ 500V DC.
- DIELECTRIC STRENGTH : 1500VAC or 2250VDC.
- Gold Plating: (Gold Flash, 1.5, 3, 6, 15, 30, 50)U" Inch

ENVIRONMENTAL:

- STORAGE : $-40^{\circ}\text{C} \sim +85^{\circ}\text{C}$.
- OPERATION : $-40^{\circ}\text{C} \sim +85^{\circ}\text{C}$.
- Wave Soldering Temperature: $255^{\circ}\text{C} \sim 265^{\circ}\text{C}$ (5 ~ 10Seconds)

MATES WITH MODULAR PLUG CONFORMING TO FCC PART 68, SUBPART F.



X:X	± 0.25	APPD:	LINK-PP INT'L TECHNOLOGY CO., LIMITED	
X:XX	± 0.20	CHKD:	TITLE: RJ45 1x1 CONNECTOR	
X:XXX	± 0.05	DR: TOM	PART NO.: LPJE101AHNL	
ANGLES	$\pm 1^{\circ}$	UNIT: mm	DWG NO.: LP10071505	
	SCALE: 2/1	SHEET: 1/1	REV: A	